

PLASMA CUTTING

The new series of Torches
Hybrid with EASY FIT
Universal torches for any plasma machine
from 20A to 160A

Registered Community Design

UPH-105 **75°**

UPH-105 **15°**

UPM-105 **180°**

UPH-125 **75°**

UPH-125 **15°**

UPM-125 **180°**

UPH-160 **85°**

UPH-160 **15°**

UPM-160 **180°**

EASY FIT
Patent

Higher performances

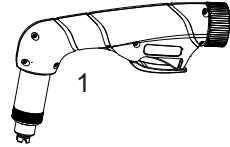
Cleaner cut

Faster speed

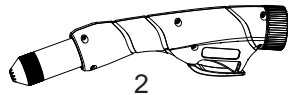
UPH-Torches Hybrid with EASY FIT

A revolutionary solution to save time and money

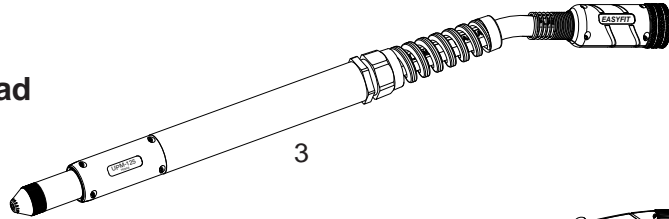
Hand torch head cutting



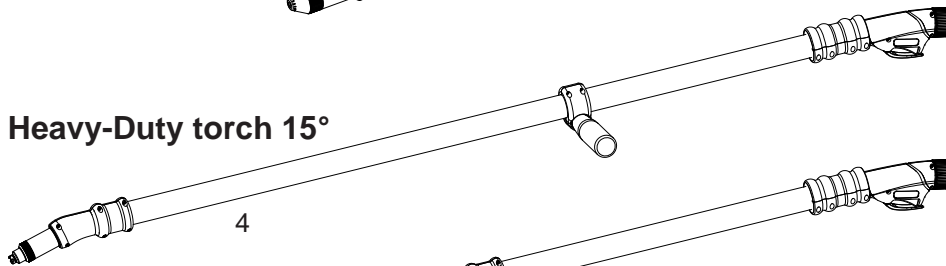
Hand torch head Gouging 15°



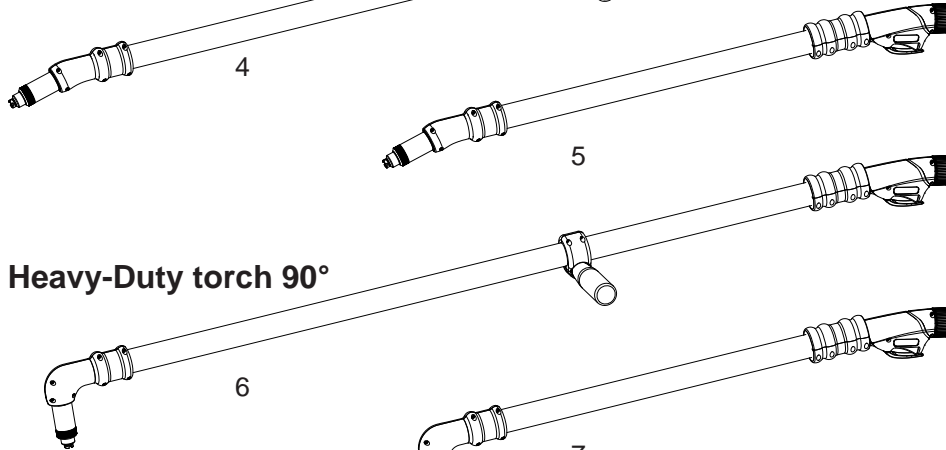
Machine torch head



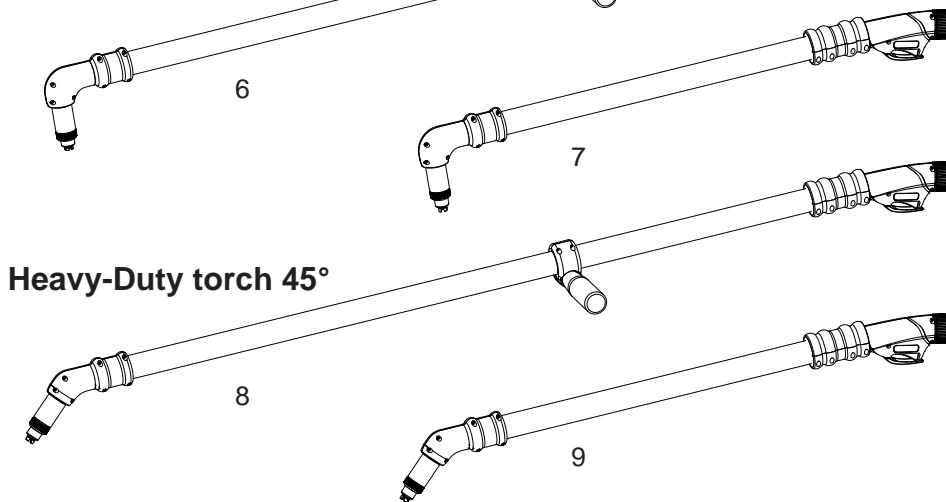
Heavy-Duty torch 15°



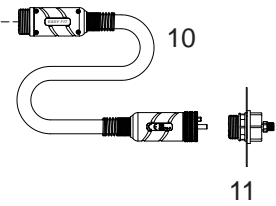
Heavy-Duty torch 90°



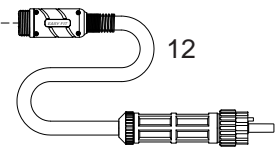
Heavy-Duty torch 45°



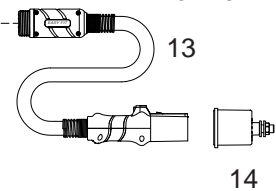
EASY FIT
Connection
Patented



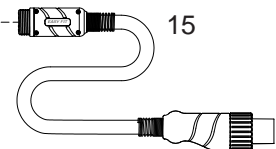
Euro Connector
Standard 5 pins



HY Connector
Patented
US 10,645,790
EP 3422822



TD Connector
Standard 4 pins



Registered Community Design



UPH-Torches Hybrid with EASY FIT

Replacement Parts

Torch head & leads

Item	Description	Code#
1	UPH-105 75° Hand Torch Head EASY FIT	05800E
	UPH-105 75° ECO Hand Torch Head EASY FIT	05800EE
	UPH-125 75° Hand Torch Head EASY FIT	05900E
	UPH-125 75° ECO Hand Torch Head EASY FIT	05900EE
	UPH-160 85° Hand Torch Head EASY FIT	03900E
2	UPH-105 15° Hand Torch Head EASY FIT	05802E
	UPH-105 15° ECO Hand Torch Head EASY FIT	05802EE
	UPH-125 15° Hand Torch Head EASY FIT	05902E
	UPH-125 15° ECO Hand Torch Head EASY FIT	05902EE
	UPH-160 15° Hand Torch Head EASY FIT	03902E
3	UPM-105 180° Machine Torch Head EASY FIT	05810E
	UPM-105 180° ECO Machine Torch Head EASY FIT	05810EE
	UPM-125 180° Machine Torch Head EASY FIT	05910E
	UPM-125 180° ECO Machine Torch Head EASY FIT	05910EE
	UPM-160 180° Machine Torch Head EASY FIT	03910E
4	UPH-105L 15° Hand Torch Heavy-Duty 130cm (52"), EASY FIT connection	05831LA
	UPH-125L 15° Hand Torch Heavy-Duty 130cm (52"), EASY FIT connection	05931LA
5	UPH-105L 15° Hand Torch Heavy-Duty 80cm (31"), EASY FIT connection	05831LB
	UPH-125L 15° Hand Torch Heavy-Duty 80cm (31"), EASY FIT connection	05931LB
6	UPH-105L 90° Hand Torch Heavy-Duty 130cm (52"), EASY FIT connection	05831LC
	UPH-125L 90° Hand Torch Heavy-Duty 130cm (52"), EASY FIT connection	05931LC
	UPH-160L 90° Hand Torch Heavy-Duty 130cm (52"), EASY FIT connection	03931LA
7	UPH-105L 90° Hand Torch Heavy-Duty 80cm (31"), EASY FIT connection	05831LD
	UPH-125L 90° Hand Torch Heavy-Duty 80cm (31"), EASY FIT connection	05931LD
	UPH-160L 90° Hand Torch Heavy-Duty 80cm (31"), EASY FIT connection	03931LB
8	UPH-125L 45° Hand Torch Heavy-Duty 130cm (52"), EASY FIT connection	05931LE
	UPH-160L 45° Hand Torch Heavy-Duty 130cm (52"), EASY FIT connection	03931LC
9	UPH-125L 45° Hand Torch Heavy-Duty 80cm (31"), EASY FIT connection	05931LF
	UPH-160L 45° Hand Torch Heavy-Duty 80cm (31"), EASY FIT connection	03931LD
10	Lead Assembly, 6m (25 ft), Coaxial Cable , EASY FIT , 6 pins, 125A max	05285FX
	Lead Assembly, 12m (50 ft), Coaxial Cable , EASY FIT , 6 pins, 125A max	05287FX
	Lead Assembly, 6m (25 ft), Coaxial Cable , EASY FIT , 6 pins, 160A max	05285FX-L
	Lead Assembly, 12m (50 ft), Coaxial Cable , EASY FIT , 6 pins, 160A max	05287FX-L
11	EASY FIT Central Connection, Machine Side, 6 pins	05265
12	Lead Assembly, 6m (20 ft), Coaxial Cable , Euro-Connector , 5 pins, 125A max	09781FX **
	Lead Assembly, 12m (40 ft), Coaxial Cable , Euro-Connector , 5 pins, 125A max	09786FX **
	Lead Assembly, 6m (20 ft), Coaxial Cable , Euro-Connector , 5 pins, 160A max	09781FX-L **
	Lead Assembly, 12m (40 ft), Coaxial Cable , Euro-Connector , 5 pins, 160A max	09786FX-L **
13	Lead Assembly, with HY Connector	on request
14	HY Central Connection, Machine Side	on request
15	Lead Assembly, with TD Connector	on request

** Connection to the system to be confirmed on the purchase order

PLASMA CUTTING TORCHES

Hybrid with EASYFIT

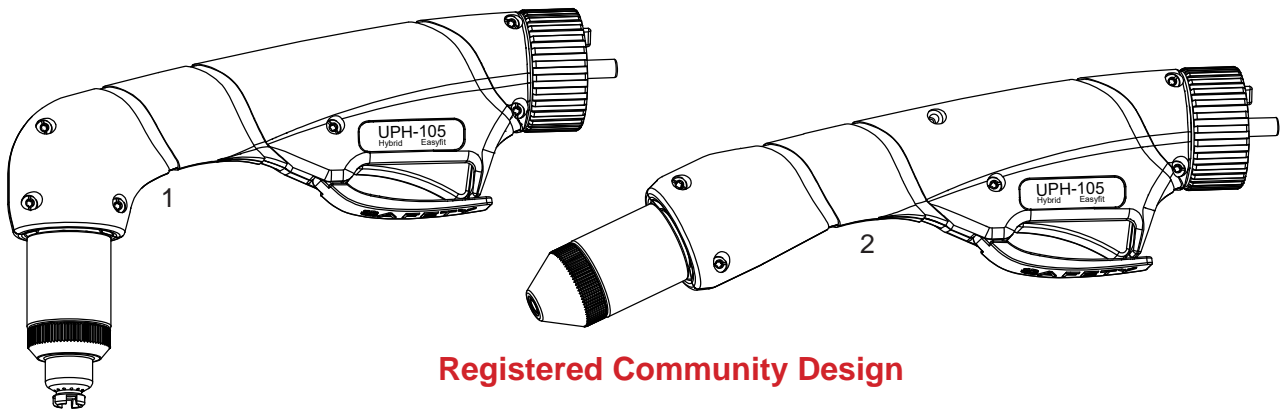
Technical Data

Current : 20-105 Amps
 Duty Cycle: 105 Amps at 60%
 Gas: Air/N2
 Gas Pressure
 - Cutting: 72-80 PSI (5.0-5.5 bar)
 - Gouging: 50-65 PSI (3.5-4.5 bar)
 Gas Flow at 105A: 510 SCFH (240 lpm)
 Post Flow Time : 45 sec
 Pilot : Electrode to Tip (12-20A)
 Ignition: Without HF

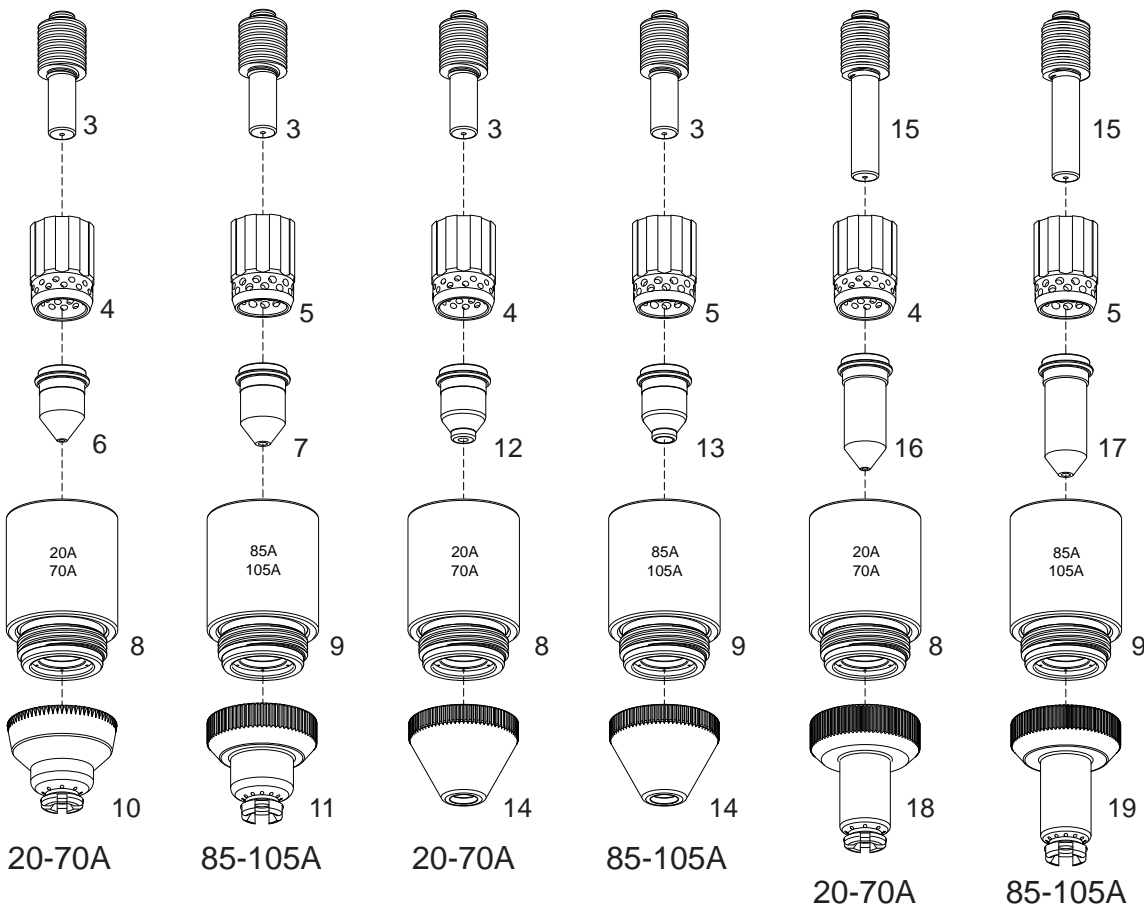
For the correct operation please use:
 3-Ways Solenoid Valve, inside orifice
 3.5-4.0mm - (0.138-0.157 inches)



Hand Torch Head complete with Handel and Parts



Registered Community Design



Contact

Gouging

Extended

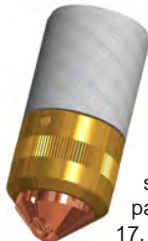
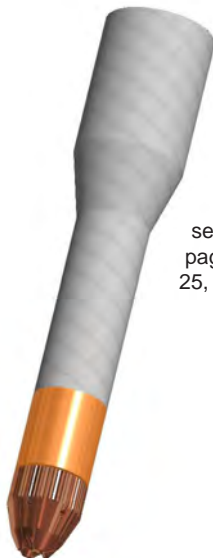
TEC.MO.[®]

PLASMA CUTTING TORCHES

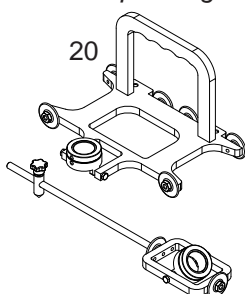
UPH-105Hybrid with *EASYFIT*

Standard Layout

- UPH-105 75°
- UPH-105 ECO 75°
- UPH-105 15°
- UPH-105 ECO 15°

UNICUT[®]see
page
17**FLATCUT**[®]see
pages
17, 20-21**AIRONCUT**[®]see
page
25, 28**Bevel Tool**

Patent pending



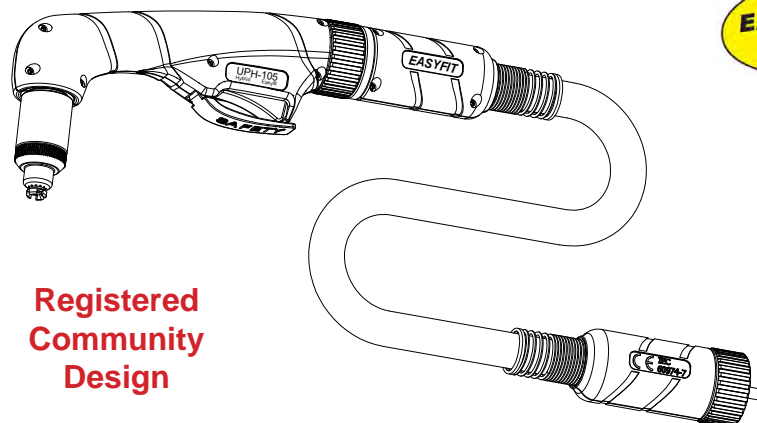
Replacement Parts

Torch parts

Item	Description	Code
1 ■	UPH-105 75° Hand Torch Head EASY FIT	05800E
■	UPH-105 ECO 75° Hand Torch Head EASY FIT	05800EE
2 ■	UPH-105 15° Hand Torch Head EASY FIT	05802E
■	UPH-105 ECO 15° Hand Torch Head EASY FIT	05802EE
n/s	O-Ring	07300.60
3 ■ ■ ■ ■	Electrode, 20-105A	52574
4 ■ ■ ■ ■	Swirl ring, 20-70A Maximum Life	60041
■ ■ ■ ■	Swirl ring, 20-70A ECO	60041E
5 ■ ■ ■ ■	Swirl ring, 85-105A Maximum Life	60024
■ ■ ■ ■	Swirl ring, 85-105A ECO	60024E
6 ■ ■ ■ ■	Tip, Contact Cutting, 45A	51206
■ ■ ■ ■	Tip, Contact Cutting, 70A	51206.11
■ ■ ■ ■	Tip, Contact Cutting, 85A	51223.13
■ ■ ■ ■	Tip, Contact Cutting, 105A	51223.15
8 ■ ■ ■ ■	Shield Cup Body, 20-70A Maximum Life	60305
■ ■ ■ ■	Shield Cup Body, 20-70A ECO	60305E
9 ■ ■ ■ ■	Shield Cup Body, 85-105A Maximum Life	60329
■ ■ ■ ■	Shield Cup Body, 85-105A ECO	60329E
10 ■ ■ ■ ■	Shield Cap, 20-70A Hand	51923
11 ■ ■ ■ ■	Shield Cap, 85-105A Hand	51941
12 ■ ■ ■ ■	Tip, Gouging, 45A	51206G
■ ■ ■ ■	Tip, Gouging, 70A	51206G.10
■ ■ ■ ■	Tip, Gouging, 105A	51223G.14
14 ■ ■ ■ ■	Shield Cap, Gouging	51924G
15 ■ ■ ■ ■	Extended Electrode, 20-105A	52574L
16 ■ ■ ■ ■	Extended Tip, 45A	51206L
■ ■ ■ ■	Extended Tip, 70A	51206L.11
17 ■ ■ ■ ■	Extended Tip, 85A	51223L.13
■ ■ ■ ■	Extended Tip, 105A	51223L.15
18 ■ ■ ■ ■	Extended Shield 20-70A	51923L
19 ■ ■ ■ ■	Extended Shield 85-105A	51941L

Accessories

n/s	Circle Cutting Attachment	51865
20	BEVEL TOOL	51880

**EASY FIT**
Patent**Registered
Community
Design**

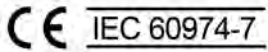
PLASMA CUTTING TORCHES

Hybrid with EASYFIT

Technical Data

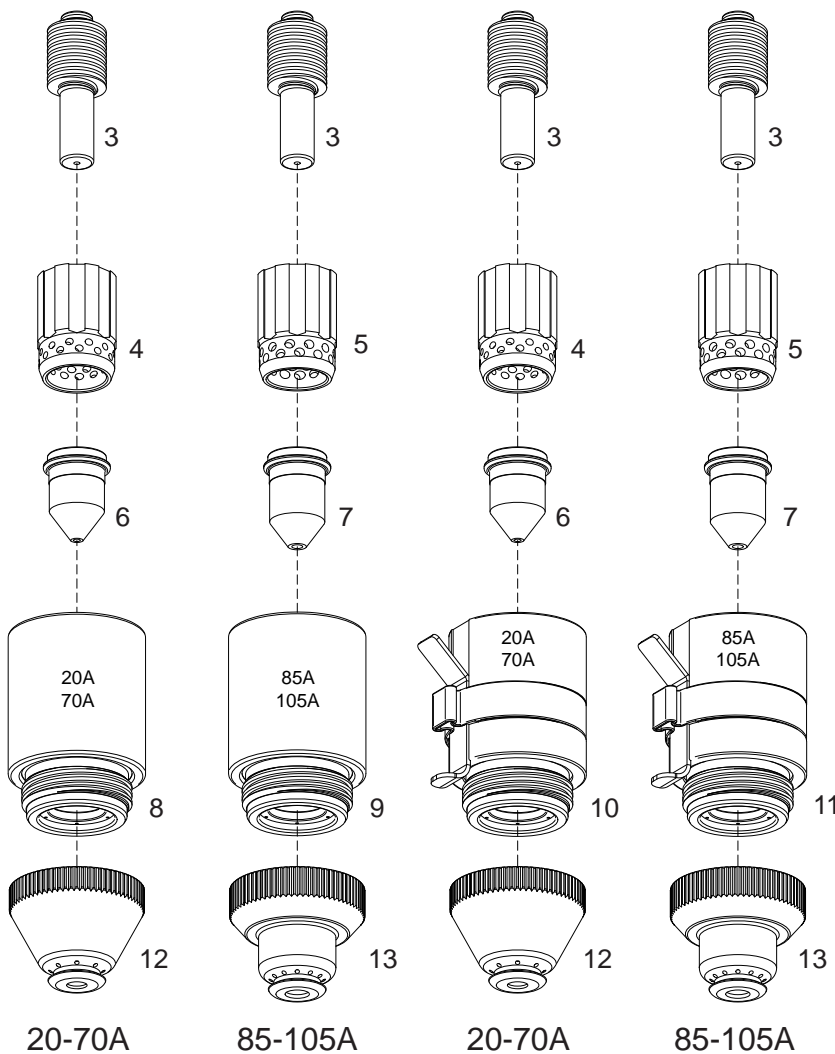
Current : 20-105 Amps
 Duty Cycle: 105 Amps at 60%
 Gas: Air/N2
 Gas Pressure
 - Cutting: 72-80 PSI (5.0-5.5 bar)
 - Gouging: 50-65 PSI (3.5-4.5 bar)
 Gas Flow at 105A: 510 SCFH (240 lpm)
 Post Flow Time : 45 sec
 Pilot : Electrode to Tip (12-20A)
 Ignition: Without HF

For the correct operation please use:
 3-Ways Solenoid Valve, inside orifice
 3.5-4.0mm - (0.138-0.157 inches)



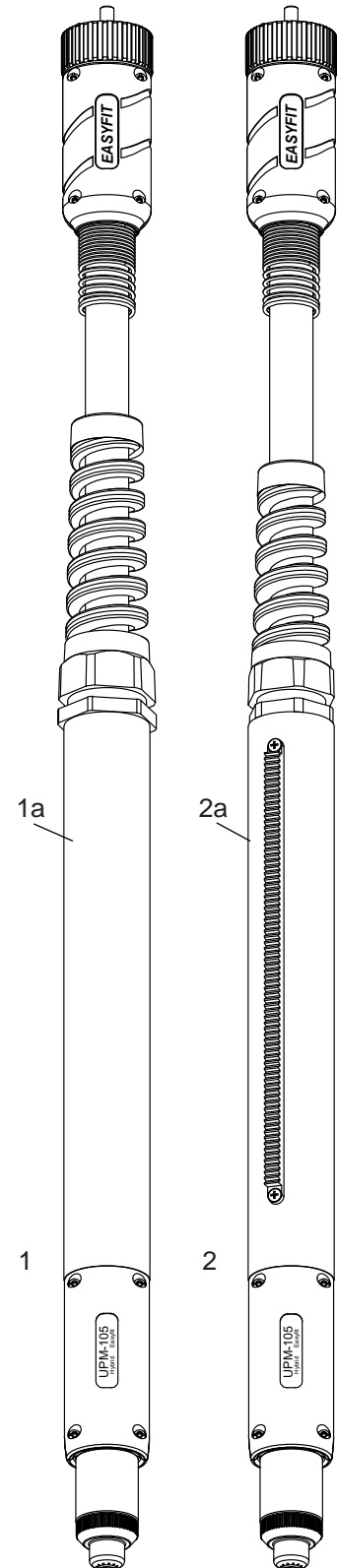
Machine Torch Head complete with Handel and Parts

Registered Community Design



Shielded

Shielded with ohmic



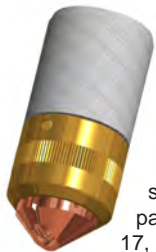
Standard Layout

- UPM-105 180°
- UPM-105 ECO 180°

UNICUT®

see
page
17

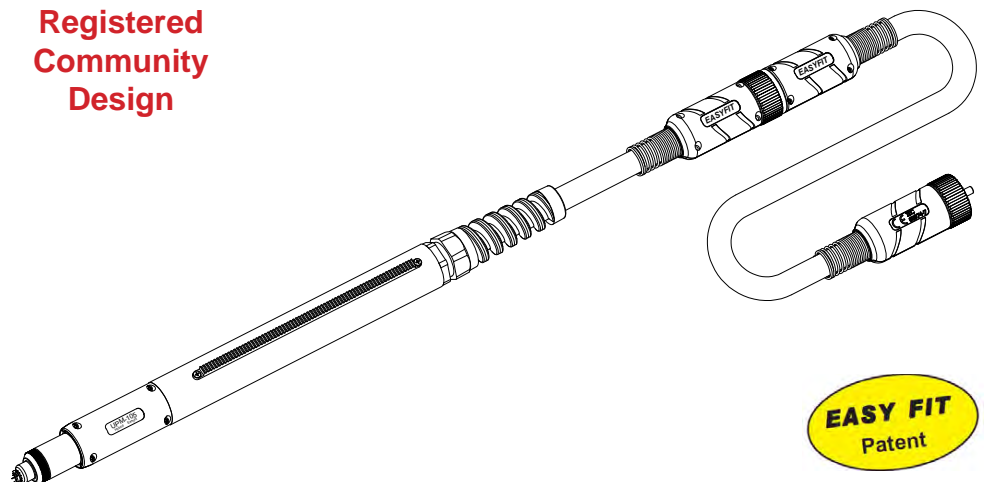
FLATCUT®

see
pages
17, 20-21Air Filter
AT-1000see
page
30

Replacement Parts

Torch parts

Item	Description	Code
1	■ UPM-105 180° Machine Torch Head EASY FIT	05810E
	■ UPM-105 ECO 180° Machine Torch Head EASY FIT	05810EE
1a	Fiberglass Positioning Tube	07218
2	■ UPM-105 180° Machine Torch Head EASY FIT , w/rack	05812E
	■ UPM-105 ECO 180° Machine Torch Head EASY FIT , w/rack	05812EE
2a	Fiberglass Positioning Tube With Rack	07219
n/s	■ ■ O-Ring	07300.60
3	■ ■ Electrode, 20-105A	52574
4	Swirl ring, 20-105A Maximum Life	60041
	Swirl ring, 20-105A ECO	60041E
5	■ Swirl ring, 85-105A Maximum Life	60024
	■ Swirl ring, 85-105A ECO	60024E
6	Tip, Cutting, 45A	51206
	Tip, Cutting, 70A	51206.11
7	Tip, Cutting, 85A	51223.13
	■ ■ Tip, Cutting, 105A	51223.15
8	Shield Cup Body, 20-70A Maximum Life	60305
	Shield Cup Body, 20-70A ECO	60305E
9	■ Shield Cup Body, 85-105A Maximum Life	60329
	■ Shield Cup Body, 85-105A ECO	60329E
10	Shield Cup Body, 20-70A Ohmic Maximum Life	60305H
	Shield Cup Body, 20-70A Ohmic ECO	60305HE
11	Shield Cup Body, 85-105A Ohmic Maximum Life	60329H
	Shield Cup Body, 85-105A Ohmic ECO	60329HE
12	Shield Cap, Machine, 45-85A	51922
13	■ ■ Shield Cap, Machine, 100-125A	51927

Registered
Community
DesignEASY FIT
Patent

PLASMA CUTTING TORCHES

Hybrid with EASYFIT

Technical Data

Current : 40-150 Amps
Duty Cycle: 125 Amps at 60%
 150 Amps at 40%

Gas: Air/N2

Gas Pressure

- Cutting 125A: 72-87 PSI (5.0-6.0 bar)
- Cutting 150A: 80-87 PSI (5.5-6.0 bar)
- Gouging: 50-65 PSI (3.5-4.5 bar)

Gas Flow at 125A: 630 SCFH (295 lpm)

Post Flow Time : 45 sec

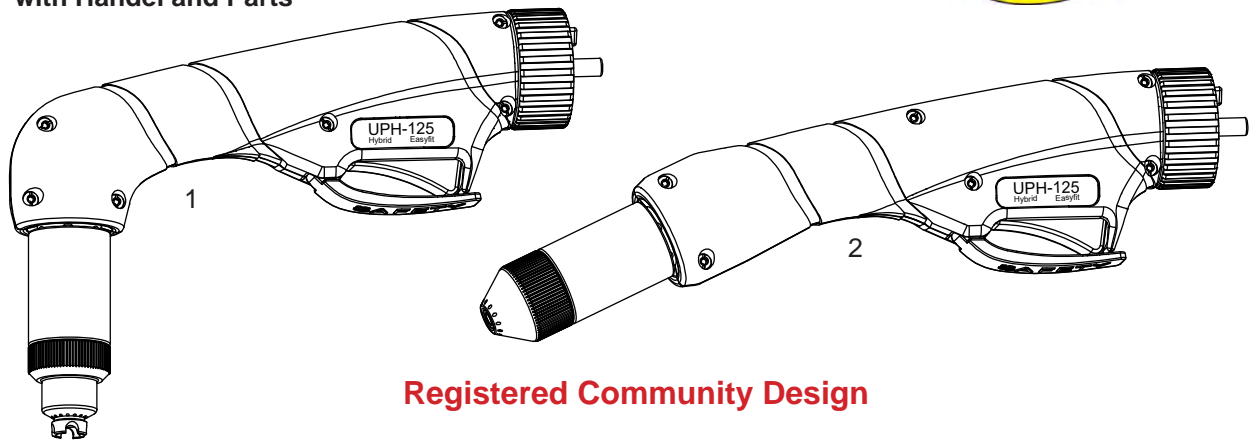
Pilot : Electrode to Tip (15-22A)

Ignition: Without HF

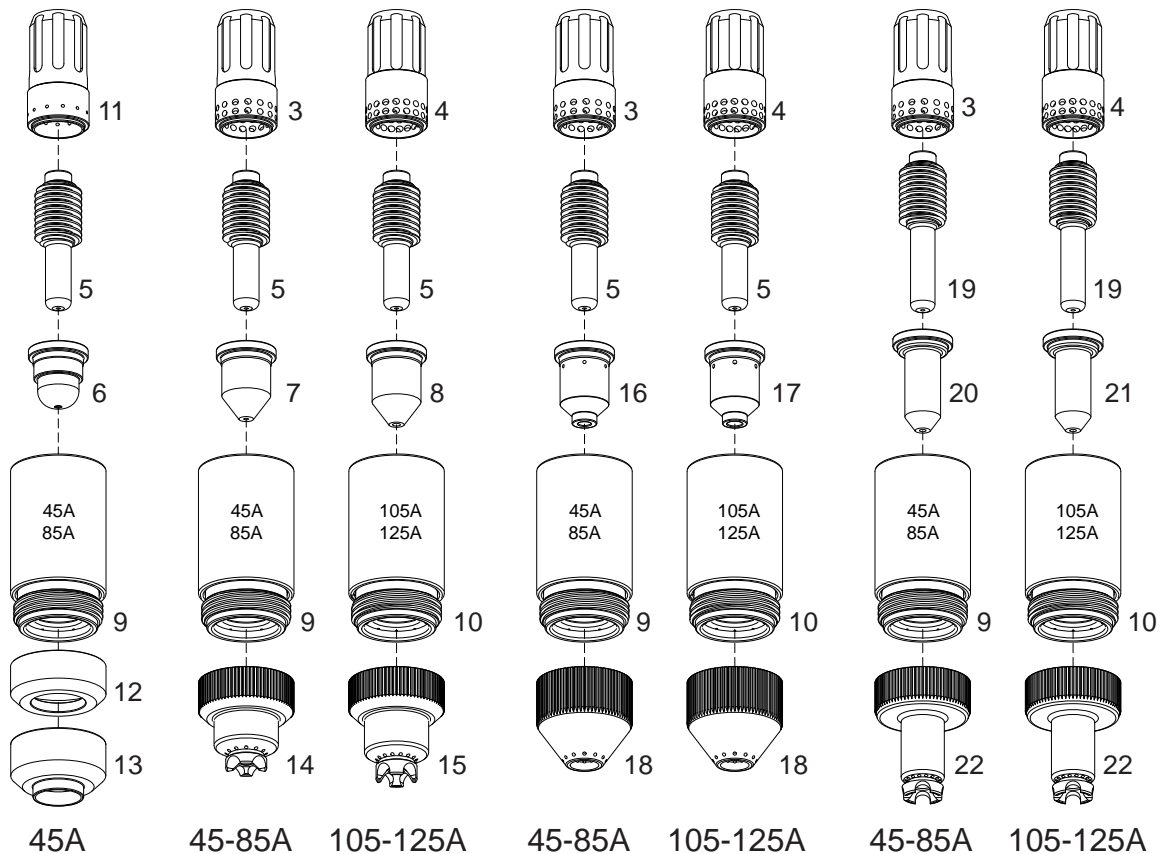
For the correct operation please use:
 3-Ways Solenoid Valve, inside orifice
 4.5-5.5mm - (0.178-0.217 inches)



Hand Torch Head complete with Handel and Parts



Registered Community Design



Precision

Cut

Contact

Gouging

Extended

Standard Layout

- **UPH-125 75°**
- **UPH-125 ECO 75°**
- **UPH-125 15°**
- **UPH-125 ECO 15°**

UNICUT[®]



see page 19

FLATCUT[®]



see pages 19, 22-23

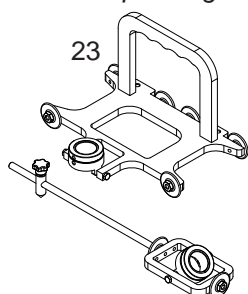
AIRONCUT[®]



see page 26

Bevel Tool

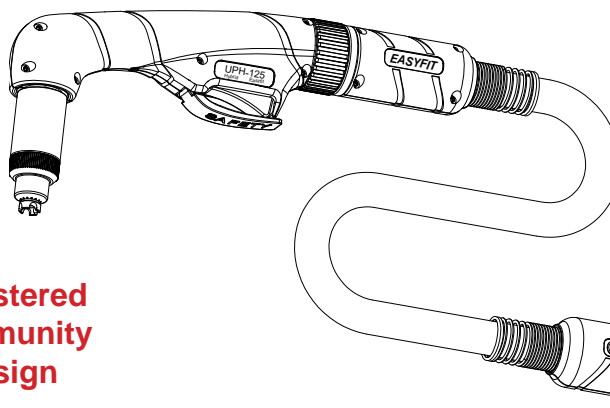
Patent pending



Replacement Parts

Torch parts

Item	Description	Code
1 ■	UPH-125 75° Hand Torch Head EASY FIT	05900E
■	UPH-125 ECO 75° Hand Torch Head EASY FIT	05900EE
2 ■	UPH-125 15° Hand Torch Head EASY FIT	05902E
■	UPH-125 ECO 15° Hand Torch Head EASY FIT	05902EE
n/s ■ ■ ■	O-Ring	03700.60
3 ■	Swirl ring, 45-85A Maximum Life	60042
■	Swirl ring, 45-85A ECO	60042E
4 ■ ■	Swirl ring, 100-125A Maximum Life	60040
■ ■	Swirl ring, 100-125A ECO	60040E
5 ■ ■ ■	Electrode, 45-125A	52677
■ ■ ■	Electrode, 45-125A, BiMetal (on request)	52677BM
6 ■	Tip, Cutting, 45A, Precision Cut	51415
7 ■	Tip, Contact Cutting, 45A	51416
■	Tip, Contact Cutting, 65A	51417
■	Tip, Contact Cutting, 85A	51418
8 ■ ■	Tip, Contact Cutting, 105A	51419
■ ■	Tip, Contact Cutting, 125A	51419.16
■ ■	Tip, Contact Cutting, 150A	51419.18
9 ■ ■	Shield Cup Body, 45-85A Maximum Life	60309AV
■ ■	Shield Cup Body, 45-85A ECO	60309A
10 ■ ■	Shield Cup Body, 100-125A Maximum Life	60309BV
■ ■	Shield Cup Body, 100-125A ECO	60309B
11 ■ ■	Swirl ring, 45A, Precision Cut, Maximum Life	60032
12 ■ ■	Deflector,	51928
13 ■ ■	Deflector, 45A, Precision Cut	51931
14 ■ ■	Shield Cap, 45-85A Hand	51921
15 ■ ■	Shield Cap, 100-125A Hand	51926
16 ■ ■	Tip, Gouging, 65-85A	51417G
17 ■ ■	Tip, Gouging, 105A	51418G
■ ■	Tip, Gouging, 125A	51419G
18 ■ ■	Shield Cap, Gouging	51927G
19 ■ ■	Extended Electrode, 45-125A	52677L
20 ■ ■	Extended Tip, 65A	51417L.12
■ ■	Extended Tip, 85A	51417L.13
21 ■ ■	Extended Tip, 105A	51417L.15
■ ■	Extended Tip, 125A	51417L.17
22 ■ ■	Extended Shield 65-125A	51923L
Accessories		
n/s ■ ■	Circle Cutting Attachment	51865
23 ■ ■	BEVEL TOOL	51880



Registered Community Design

PLASMA CUTTING TORCHES

Hybrid with EASYFIT

Technical Data

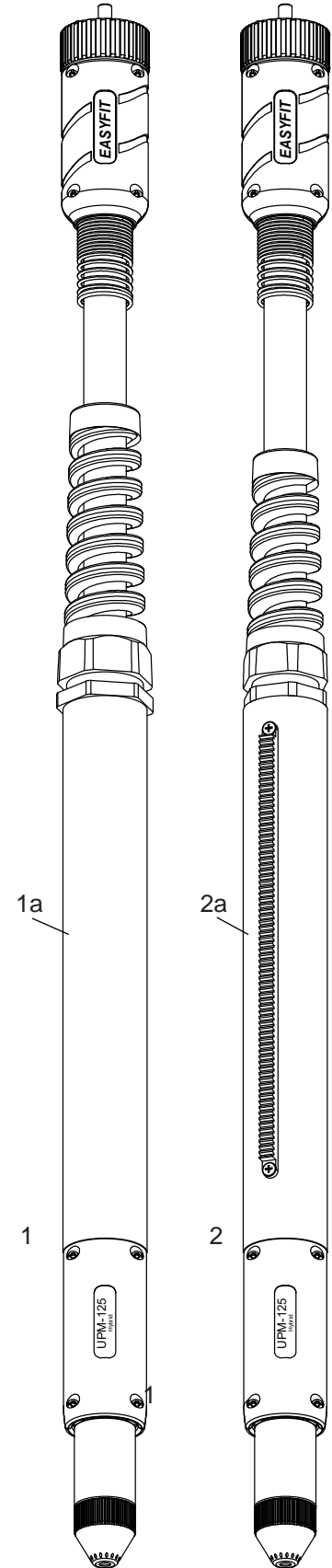
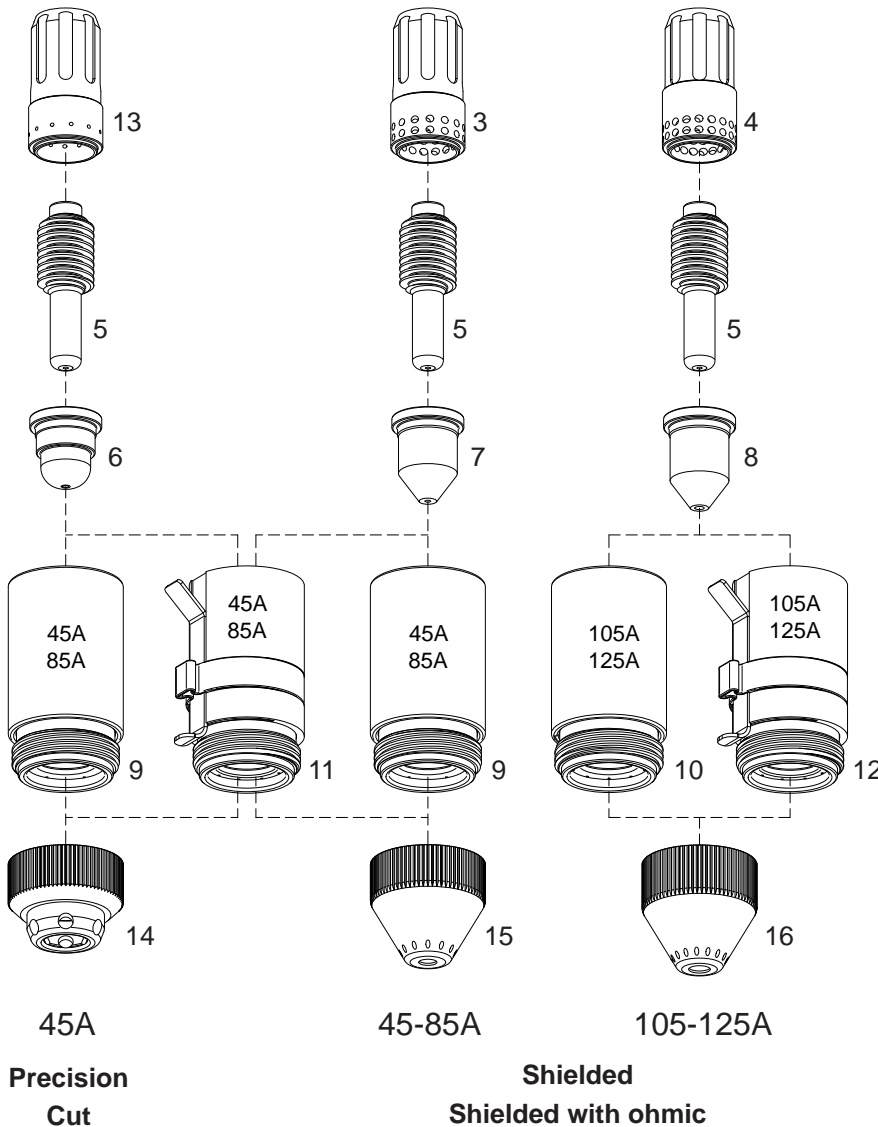
Current :	40-125 Amps
Duty Cycle:	125 Amps at 60%
Gas:	Air/N2
Gas Pressure	
- Cutting:	72-87 PSI (5.0-6.0 bar)
- Gouging:	50-65 PSI (3.5-4.5 bar)
Gas Flow at 125A:	630 SCFH (295 lpm)
Post Flow Time :	45 sec
Pilot :	Electrode to Tip (15-22A)
Ignition:	Without HF

For the correct operation please use:
3-Ways Solenoid Valve, inside orifice
4.5-5.5mm - (0.178-0.217 inches)



Machine Torch Head complete with Handel and Parts

Registered Community Design



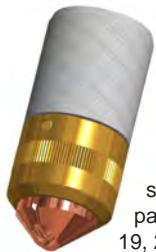
Standard Layout

- UPM-125 180°
- UPM-125 ECO 180°

UNICUT®

see
page
19

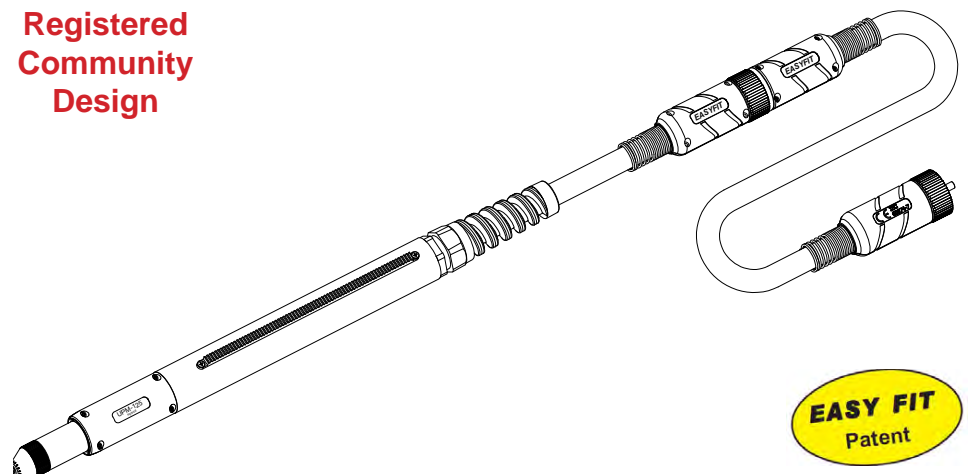
FLATCUT®

see
pages
19, 22-23Air Filter
AT-1000see
page
30

Replacement Parts

Torch parts

Item	Description	Code
1	■ UPM-125 180° Machine Torch Head EASY FIT	05910E
	■ UPM-125 ECO 180° Machine Torch Head EASY FIT	05910EE
1a	Fiberglass Positioning Tube	07218
2	■ UPM-125 180° Machine Torch Head EASY FIT , w/rack	05912E
	■ UPM-125 ECO 180° Machine Torch Head EASY FIT , w/rack	05912EE
2a	Fiberglass Positioning Tube With Rack	07219
3	Swirl ring, 45-85A Maximum Life	60042
	Swirl ring, 45-85A ECO	60042E
4	■ Swirl ring, 100-125A Maximum Life	60040
	■ Swirl ring, 100-125A ECO	60040E
5	■ Electrode, 45-125A	52677
	■ Electrode, 45-125A, BiMetal (on request)	52677BM
6	Tip, Cutting, 45A, Precision Cut	51415
7	Tip, Contact Cutting, 45A	51416
	Tip, Contact Cutting, 65A	51417
	Tip, Contact Cutting, 85A	51418
8	Tip, Contact Cutting, 105A	51419
	■ Tip, Contact Cutting, 125A	51419.16
9	Shield Cup Body, 45-85A Maximum Life	60309AV
	Shield Cup Body, 45-85A ECO	60309A
10	■ Shield Cup Body, 100-125A Maximum Life	60309BV
	■ Shield Cup Body, 100-125A ECO	60309B
11	Shield Cup Body, 45-85A Ohmic Maximum Life	60309HA
12	Shield Cup Body, 100-125A Ohmic Maximum Life	60309HB
13	Swirl ring, 45A, Precision Cut, Maximum Life	60032
14	Shield Cap, 45A, Precision Cut	51929
15	Shield Cap, Machine, 45-85A	51922
16	■ Shield Cap, Machine, 100-125A	51927

Registered
Community
Design**EASY FIT**
Patent

PLASMA CUTTING TORCHES

Hybrid with EASYFIT

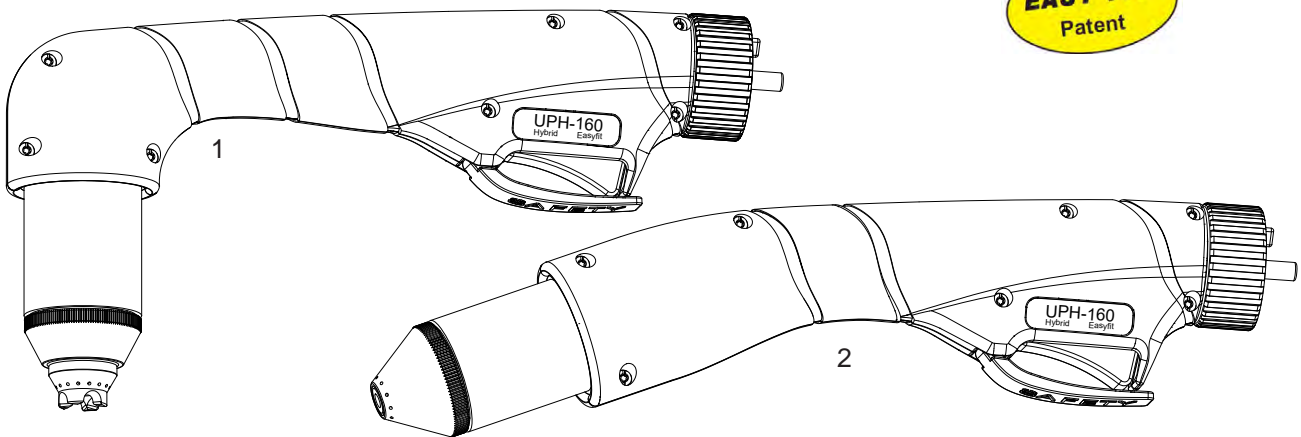
Technical Data

Current : 30-160 Amps
 Duty Cycle: 160 Amps at 60%
 Gas: Air/N2
 Gas Pressure
 - Cutting: 72-87 PSI (5.0-6.0 bar)
 - Gouging: 40-46 PSI (3.0-3.5 bar)
 Gas Flow at 160A: 850 SCFH (420 lpm)
 Post Flow Time : 45 sec
 Pilot : Electrode to Tip (22-25A)
 Ignition: Without HF

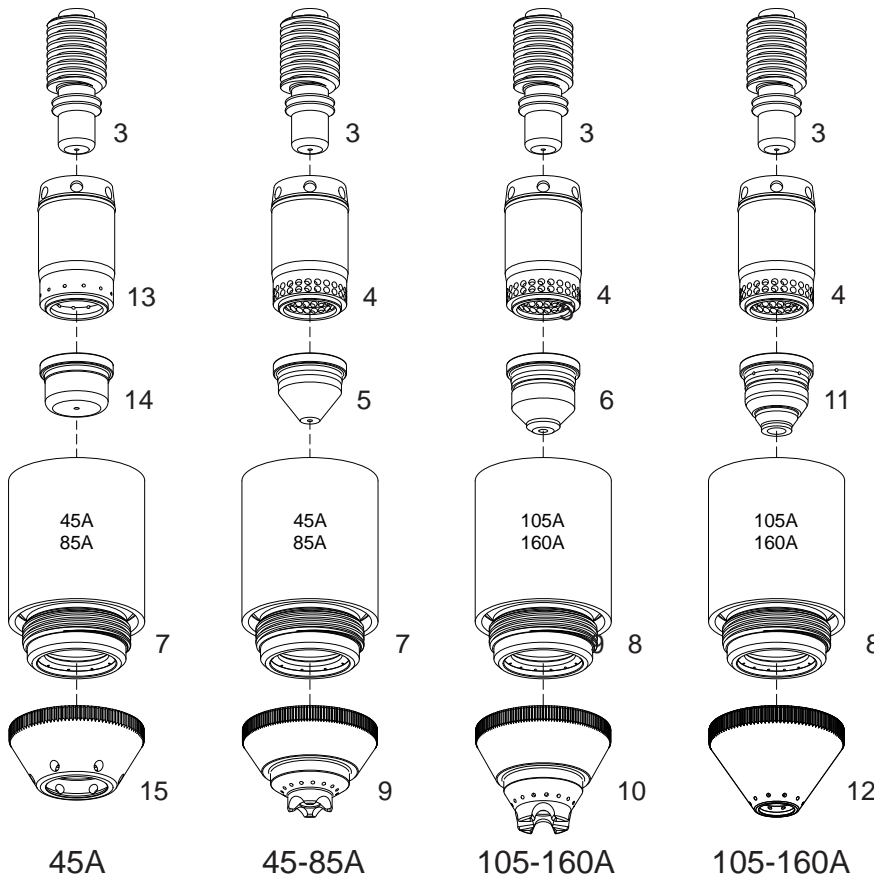
For the correct operation please use:
 3-Ways Solenoid Valve, inside orifice
 4.5-5.5mm - (0.178-0.217 inches)



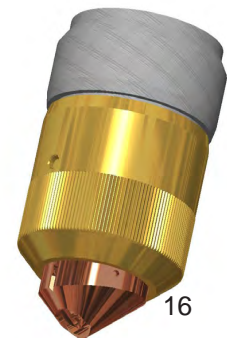
Hand Torch Head complete with Handel and Parts



Registered Community Design

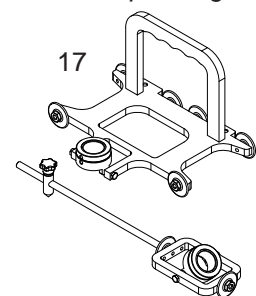


FLATCUT®



see
page
24

Bevel Tool
Patent pending



Precision

Cut

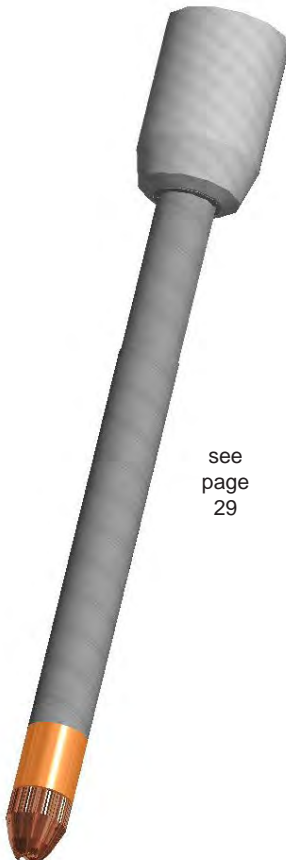
Contact

Gouging

Standard Layout

- UPH-160 85°
- UPH-160 15°

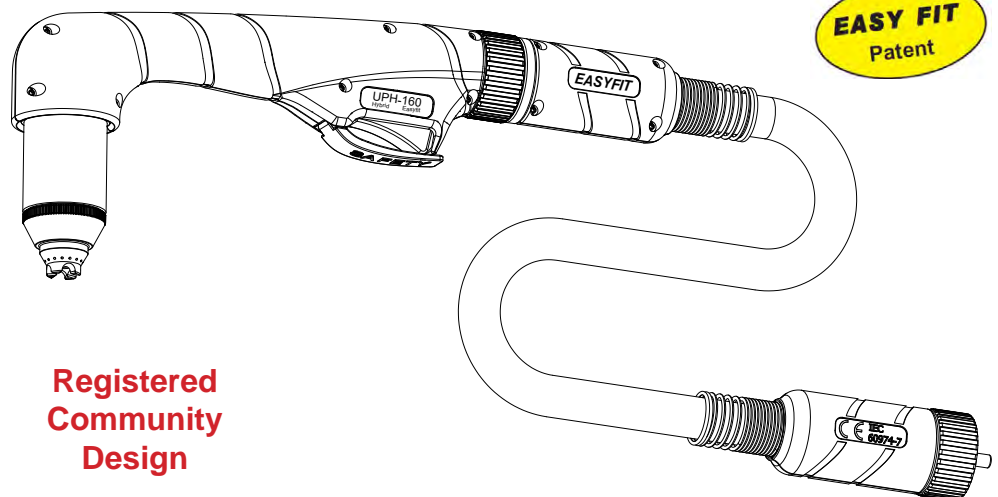
AIRONCUT®

see
pages
27AIRONCUT
XXXL®see
page
29

Replacement Parts

Torch parts

Item	Description	Code
1	■ UPH-160 85° Hand Torch Head EASY FIT	03900E
2	■ UPH-160 15° Hand Torch Head EASY FIT	03902E
n/s	■ O-Ring	03900.60
3	■ Electrode, <i>Patent Pending</i>	52678
	Electrode, BiMetal , <i>Patent Pending</i> , (on request)	52678BM
4	■ Swirl ring Maximum Life	60039
	Swirl ring ECO	60039E
5	Tip, Cutting, 45A	51420
	Tip, Cutting, 65A	51421
	Tip, Cutting, 85A	51422
6	Tip, Cutting, 105-125A	51425
	Tip, Cutting, 160A	51426
7	Shield Cup Body, 45-85A	60311TA
8	■ Shield Cup Body, 105-160A	60311TB
9	Shield Cap, Hand, 45-85A	51916T
10	Shield Cap, Hand, 105-160A	51917T
11	Tip, Gouging, 105-125A	51424G
	Tip, Gouging, 160A	51425G
12	Shield Cap, Gouging	51919G
13	Swirl ring, Precision Cut (Hand Cutting)	60033
14	Tip, 30-45A, Precision Cut	51428
15	Deflector, Precision Cut	51915
16	Standard KIT FLATCUT 85-125A NEW	53637
	Standard KIT FLATCUT 130-160A NEW	53638
Accessories		
n/s	Circle Cutting Attachment	51868
17	BEVEL TOOL	51886

Registered
Community
Design

PLASMA CUTTING TORCHES

Hybrid with EASYFIT

Technical Data

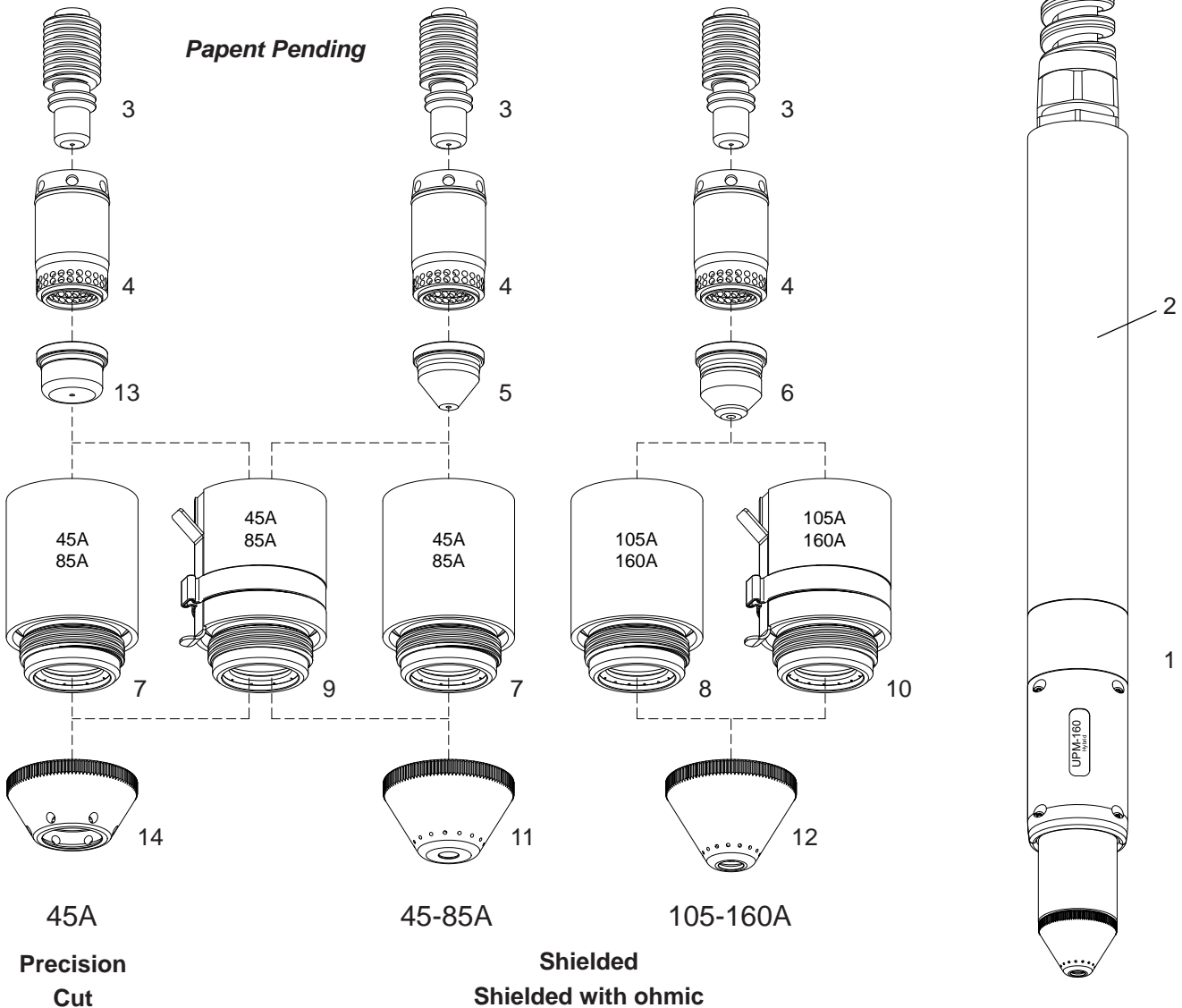
Current : 30-160 Amps
 Duty Cycle: 160 Amps at 60%
 Gas: Air/N2
 Gas Pressure
 - Cutting: 72-87 PSI (5.0-6.0 bar)
 - Gouging: 40-46 PSI (3.0-3.5 bar)
 Gas Flow at 125A: 850 SCFH (420 lpm)
 Post Flow Time : 45 sec
 Pilot : Electrode to Tip (22-25A)
 Ignition: Without HF

For the correct operation please use:
 3-Ways Solenoid Valve, inside orifice
 4.5-5.5mm - (0.178-0.217 inches)



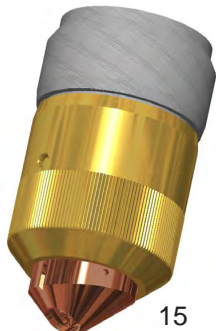
Machine Torch Head complete with Handel and Parts

Registered Community Design



Standard Layout
 ■ UPM-160 180°

FLATCUT®



see
page
24

Air Filter
AT-1000



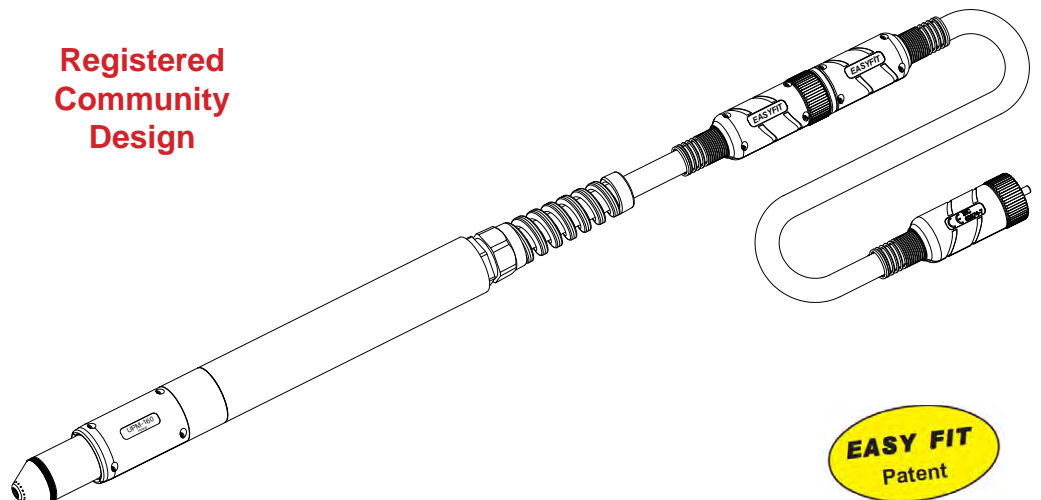
see
page
30

Replacement Parts

Torch parts

Item	Description	Code
1	■ UPM-160 180° Machine Torch Head EASY FIT	03910E
n/s	O-Ring	03900.60
2	■ Fiberglass Positioning Tube	03916
3	■ Electrode Patent Pending	52678
	Electrode, BiMetal , Patent Pending (on request)	52678BM
4	■ Swirl ring Maximum Life	60039
	Swirl ring ECO	60039E
5	Tip, Cutting, 45A	51420
	Tip, Cutting, 65A	51421
	Tip, Cutting, 85A	51422
6	Tip, Cutting, 105-125A	51425
	■ Tip, Cutting, 160A	51426
7	Shield Cup Body, 45-85A	60311TA
8	■ Shield Cup Body, 105-160A	60311TB
9	Shield Cup Body, 45-85A Ohmic	60311THA
10	Shield Cup Body, 105-160A Ohmic	60311THB
11	Shield Cap, Machine, 45-85A	51918T
12	■ Shield Cap, Machine, 105-160A	51919T
13	Tip, 30-45A, Precision Cut	51428
14	Deflector, Precision Cut	51915
15	Standard KIT FLATCUT 85-125A NEW	53637
	Standard KIT FLATCUT 130-160A NEW	53638

Registered
Community
Design



EASY FIT
Patent

First Kit of Standard Consumables



image for example purposes only

Code	Description
BLKUPH105-045	First kit for Hand torch 45A
BLKUPH105-070	First kit for Hand torch 70A
BLKUPH105-085	First kit for Hand torch 85A
BLKUPH105-105	First kit for Hand torch 105A
BLKUPM105-045	First kit for Machine torch 45A
BLKUPM105-070	First kit for Machine torch 70A
BLKUPM105-085	First kit for Machine torch 85A
BLKUPM105-105	First kit for Machine torch 105A



Custom made to order

Code	Description
BXAUPH105-045	BOX for Hand torch 45A
BXAUPH105-070	BOX for Hand torch 70A
BXAUPH105-085	BOX for Hand torch 85A
BXAUPH105-105	BOX for Hand torch 105A
BXAUPM105-045	BOX for Machine torch 45A
BXAUPM105-070	BOX for Machine torch 70A
BXAUPM105-085	BOX for Machine torch 85A
BXAUPM105-105	BOX for Machine torch 105A




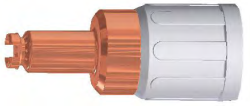
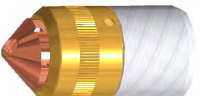
Custom made to order



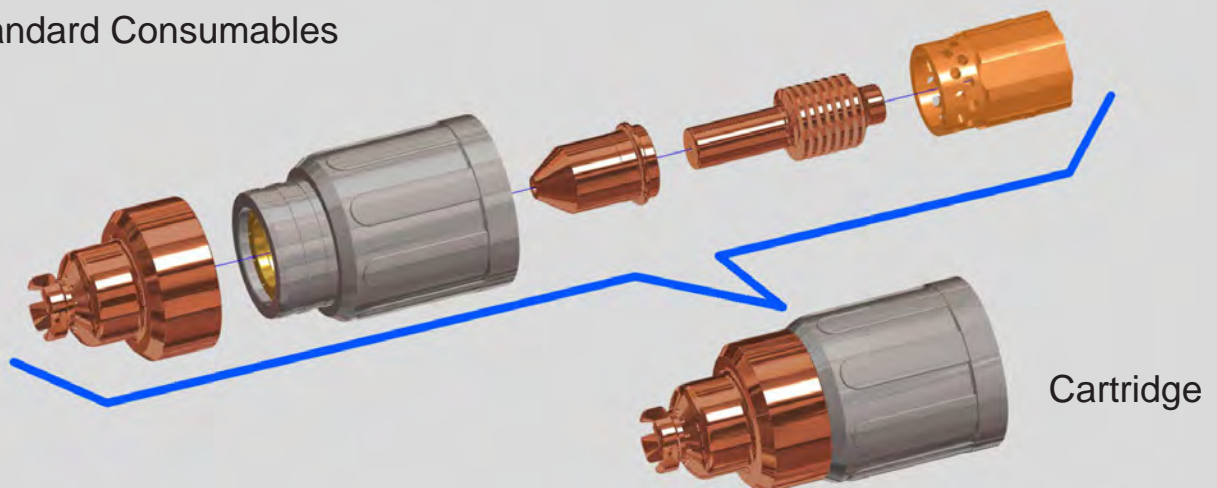
image for example purposes only

Code	Description
BXBUPH105-045	BOX mini for Hand torch 45A
BXBUPH105-070	BOX mini for Hand torch 70A
BXBUPH105-085	BOX mini for Hand torch 85A
BXBUPH105-105	BOX mini for Hand torch 105A
BXBUPM105-045	BOX mini for Machine torch 45A
BXBUPM105-070	BOX mini for Machine torch 70A
BXBUPM105-085	BOX mini for Machine torch 85A
BXBUPM105-105	BOX mini for Machine torch 105A

UNICUT®**Single-use cartridges PLUG and CUT**

	Code	Description
Hand 	53601M	Cartridge UPH-70/105 45A hand cutting
	53602M	Cartridge UPH-70/105 70A hand cutting
	53603M	Cartridge UPH-105 85A hand cutting
	53604M	Cartridge UPH-105 105A hand cutting
Automation 	53606M	Cartridge UPM-70/105 45A machine cutting
	53607M	Cartridge UPM-70/105 70A machine cutting
	53608M	Cartridge UPM-105 85A machine cutting
	53609M	Cartridge UPM-105 105A machine cutting
	53671.44	Clip OHMIC (pcs.3)
Gouging 	53611M	Cartridge UPH-70/105 45A Gouging
	53612M	Cartridge UPH-70/105 70A Gouging
	53613M	Cartridge UPH-105 105A Gouging
Extended 	53615M	Cartridge UPH-70/105 45A Extended hand cutting
	53616M	Cartridge UPH-70/105 70A Extended hand cutting
	53617M	Cartridge UPH-105 85A Extended hand cutting
	53618M	Cartridge UPH-105 105A Extended hand cutting
FLATCUT ® 	53630	Cartridge UPH-70/105 40/70A FLATCUT
	53631	Cartridge UPH-70/105 80/105A FLATCUT

Standard Consumables



First Kit of Standard Consumables



image for example purposes only

Code	Description
BLKUPH125-045	First kit for Hand torch 45A
BLKUPH125-065	First kit for Hand torch 65A
BLKUPH125-085	First kit for Hand torch 85A
BLKUPH125-105	First kit for Hand torch 105A
BLKUPH125-125	First kit for Hand torch 125A
BLKUPM125-045	First kit for Machine torch 45A
BLKUPM125-065	First kit for Machine torch 70A
BLKUPM125-085	First kit for Machine torch 85A
BLKUPM125-105	First kit for Machine torch 105A
BLKUPM125-125	First kit for Machine torch 125A



Custom made to order

Code	Description
BXAUPH125-045	BOX for Hand torch 45A
BXAUPH125-065	BOX for Hand torch 65A
BXAUPH125-085	BOX for Hand torch 85A
BXAUPH125-105	BOX for Hand torch 105A
BXAUPH125-125	BOX for Hand torch 125A
BXAUPM125-045	BOX for Machine torch 45A
BXAUPM125-065	BOX for Machine torch 65A
BXAUPM125-085	BOX for Machine torch 85A
BXAUPM125-105	BOX for Machine torch 105A
BXAUPM125-125	BOX for Machine torch 125A


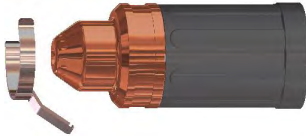

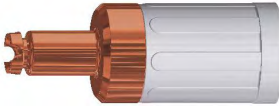
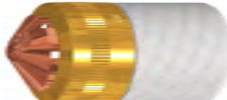
Custom made to order

Code	Description
BXBUPH125-045	BOX mini for Hand torch 45A
BXBUPH125-065	BOX mini for Hand torch 65A
BXBUPH125-085	BOX mini for Hand torch 85A
BXBUPH125-105	BOX mini for Hand torch 105A
BXBUPH125-125	BOX mini for Hand torch 125A
BXBUPM125-045	BOX mini for Machine torch 45A
BXBUPM125-065	BOX mini for Machine torch 65A
BXBUPM125-085	BOX mini for Machine torch 85A
BXBUPM125-105	BOX mini for Machine torch 105A
BXBUPM125-125	BOX mini for Machine torch 125A

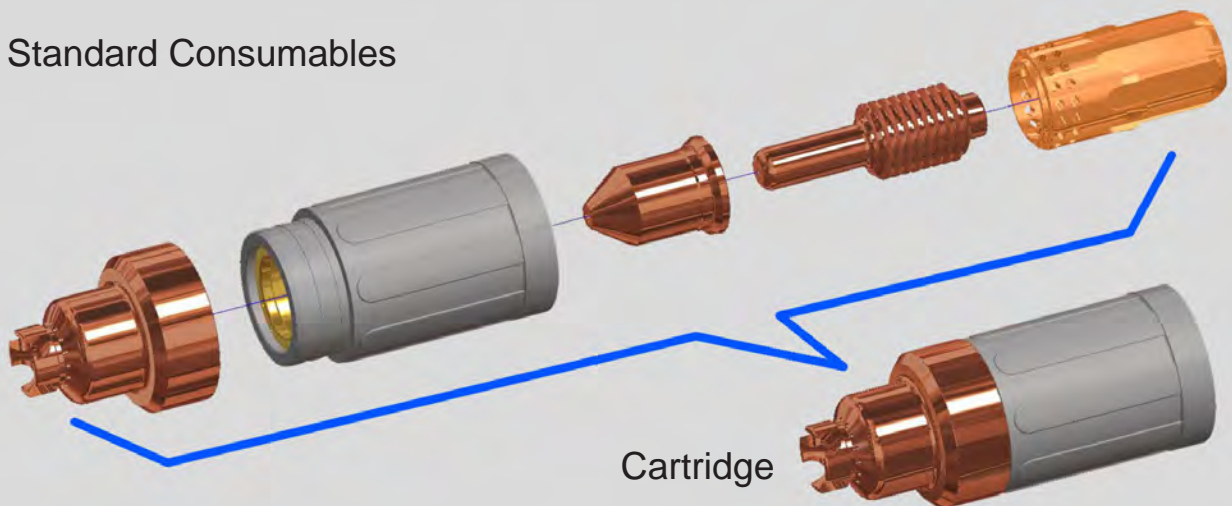


image for example purposes only

UNICUT®**Single-use cartridges PLUG and CUT**

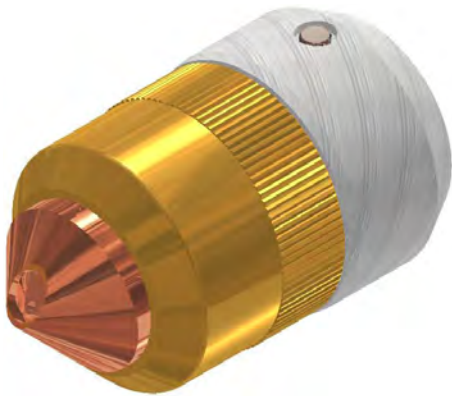
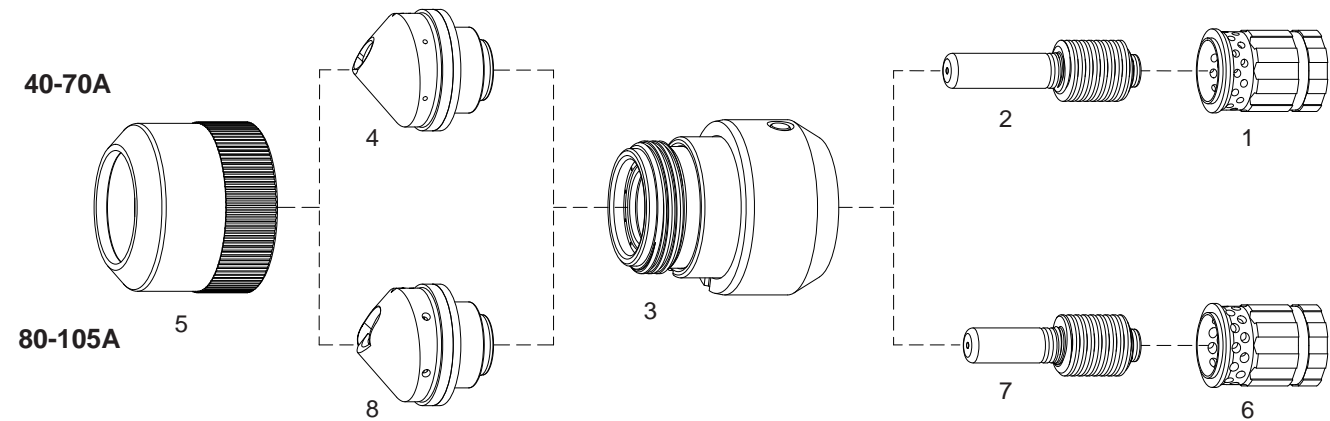
	Code	Description
Hand 	53641M	Cartridge UPH-125 45A hand cutting
	53642M	Cartridge UPH-125 65A hand cutting
	53643M	Cartridge UPH-125 85A hand cutting
	53644M	Cartridge UPH-125 105A hand cutting
	53645M	Cartridge UPH-125 125A hand cutting
Automation 	53647M	Cartridge UPM-125 45A machine cutting
	53648M	Cartridge UPM-125 65A machine cutting
	53649M	Cartridge UPM-125 85A machine cutting
	53650M	Cartridge UPM-125 105A machine cutting
	53651M	Cartridge UPM-125 125A machine cutting
	53672.44	Clip OHMIC (pcs.3)
Gouging 	53654M	Cartridge UPH-125 65/85A Gouging
	53655M	Cartridge UPH-125 105A Gouging
	53656M	Cartridge UPH-125 125A Gouging
Extended 	53659M	Cartridge UPH-125 65A Extended hand cutting
	53660M	Cartridge UPH-125 85A Extended hand cutting
	53661M	Cartridge UPH-125 105A Extended hand cutting
	53662M	Cartridge UPH-125 125A Extended hand cutting
FLATCUT ® 	53632	Cartridge UPH-125 40/70A FLATCUT
	53633	Cartridge UPH-125 80/125A FLATCUT

Standard Consumables

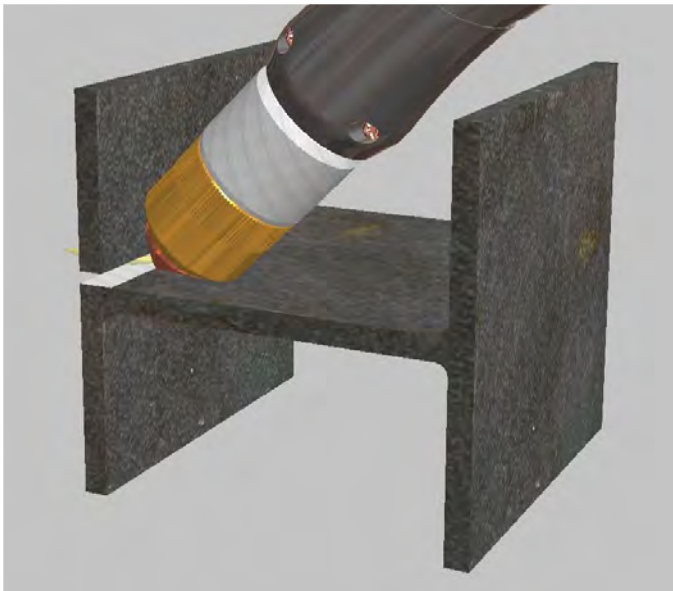


FLATCUT®

with 45 degree inclined arc for cutting Flat



#	Code	Description	Pkg
	53501	Standard KIT 40-70A	1
1	60075	Swirl Ring 40-70A	2
2	53519	Electrode 40-70A	5
3	53510	Retaining Cap	1
4	53530	Tip 40/70A	5
5	53541	Retaining Ring	2
	53502	Standard KIT 80-105A	1
6	60076	Swirl Ring 80-105A	2
7	53520	Electrode 80-105A	5
3	53510	Retaining Cap	1
8	53531	Tip 80-105A	5
5	53541	Retaining Ring	2



FLATCUT®

Some cutting examples that can be performed
with the FLATCUT

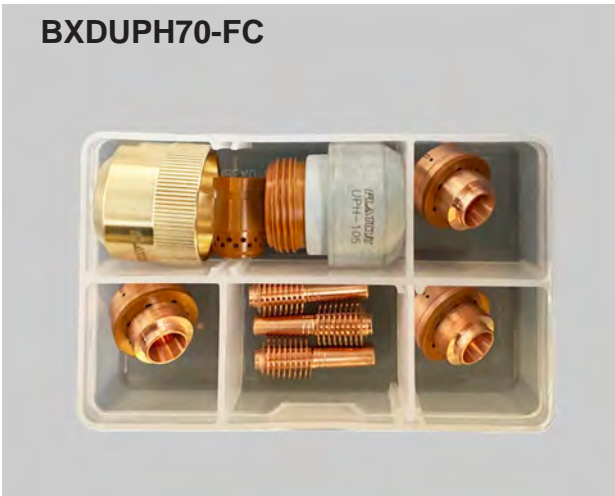
BXAUPH105-FC



BXAUPH105-FC Special Box

Code	Description	Qty
60075	Swirl Ring 40-70A	1
53519	Electrode 40-70A	5
53530	Tip 40-70A	5
60076	Swirl Ring 80-105A	1
53520	Electrode 80-105A	5
53531	Tip 80-105A	5
53502	Standard KIT 80-105A	1

BXDUPH70-FC



BXDUPH70-FC Mini Kit 40-70A

Code	Description	Qty
60075	Swirl Ring 40-70A	1
53519	Electrode 40-70A	3
53510	Retaining Cap	1
53530	Tip 40-70A	3
53541	Retaining Ring	1

BXDUPH105-FC

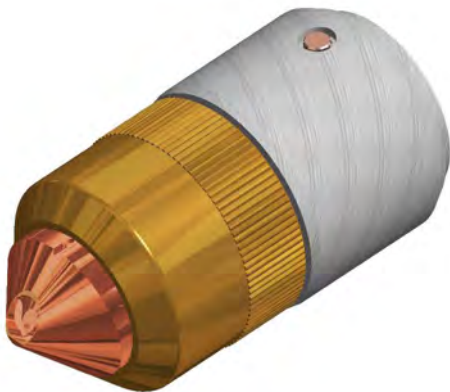
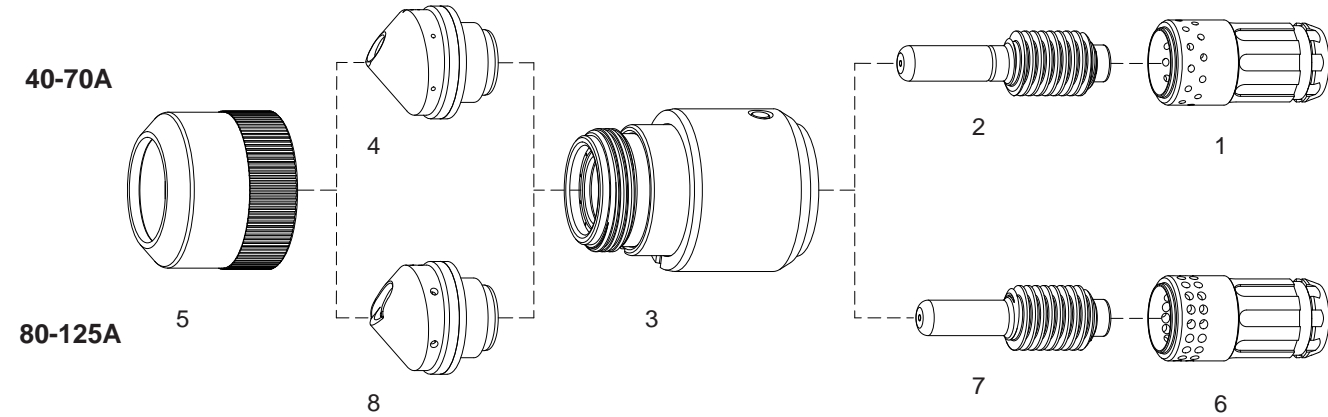


BXDUPH105-FC Mini Kit 80-105A

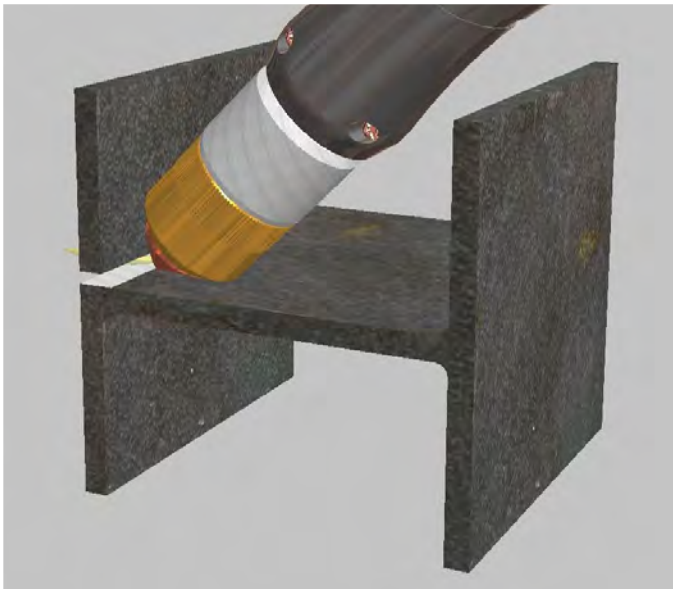
Code	Description	Qty
60076	Swirl Ring 80-105A	1
53520	Electrode 80-105A	3
53510	Retaining Cap	1
53531	Tip 80-105A	3
53541	Retaining Ring	1

FLATCUT®

with 45 degree inclined arc for cutting Flat



#	Code	Description	Pkg
	53504	Standard KIT 40-70A	1
1	60062	Swirl Ring 40-70A	2
2	53521	Electrode 40-70A	5
3	53511	Retaining Cap	1
4	53532	Tip 40-70A	5
5	53541	Retaining Ring	2
	53505	Standard KIT 80-125A	1
6	60063	Swirl Ring 80-125A	2
7	52677	Electrode 80-125A	5
3	53511	Retaining Cap	1
8	53533	Tip 80-125A	5
5	53541	Retaining Ring	2

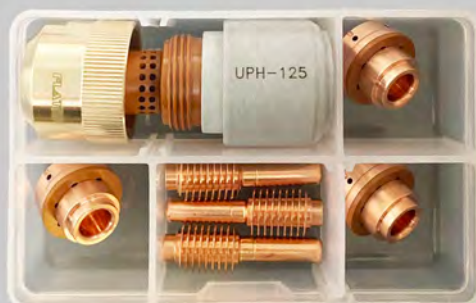


FLATCUT®

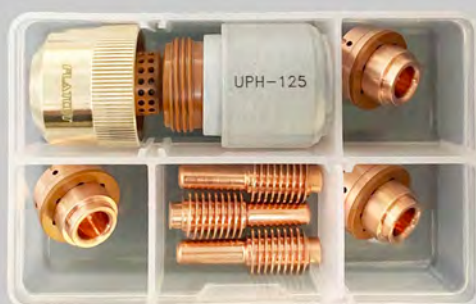
Some cutting examples that can be performed
with the FLATCUT

BXAUPH125-FC**BXAUPH125-FC Special Box**

Code	Description	Qty
60062	Swirl Ring 40-70A	1
53521	Electrode 40-70A	5
53532	Tip 40-70A	5
60063	Swirl Ring 80-125A	1
52677	Electrode 80-125A	5
53533	Tip 80-125A	5
53505	Standard KIT 80-125A	1

BXDUPH125-70FC**BXDUPH125-70FC Mini Kit 40-70A**

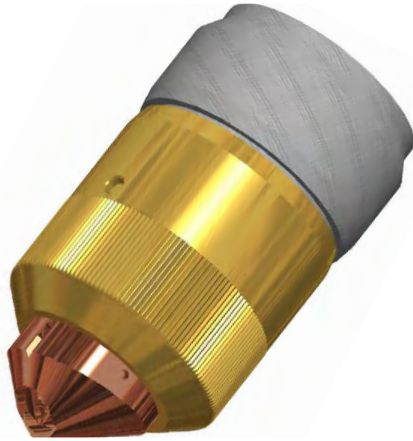
Code	Description	Qty
60062	Swirl Ring 40-70A	1
53521	Electrode 40-70A	3
53511	Retaining Cap	1
53532	Tip 40-70A	3
53541	Retaining Ring	1

BXDUPH125-125FC**BXDUPH125-125FC Mini Kit 80-125A**

Code	Description	Qty
60063	Swirl Ring 80-125A	1
52677	Electrode 80-125A	3
53511	Retaining Cap	1
53533	Tip 80-125A	3
53541	Retaining Ring	1

FLATCUT®

with 45 degree inclined arc for cutting Flat



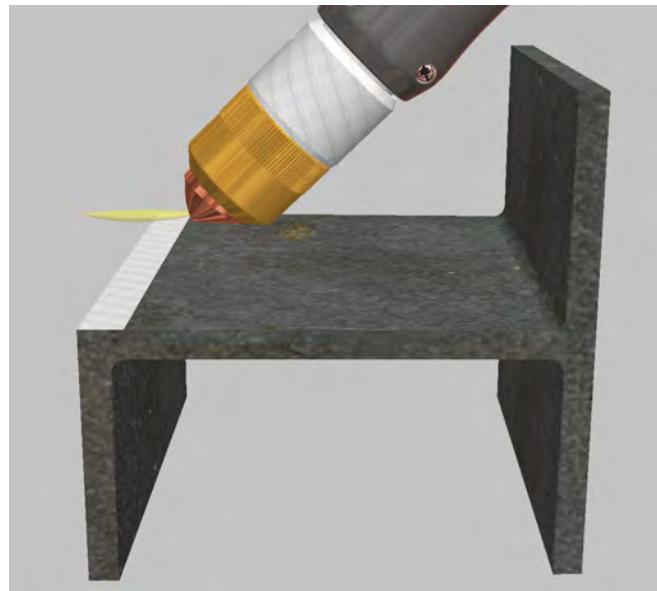
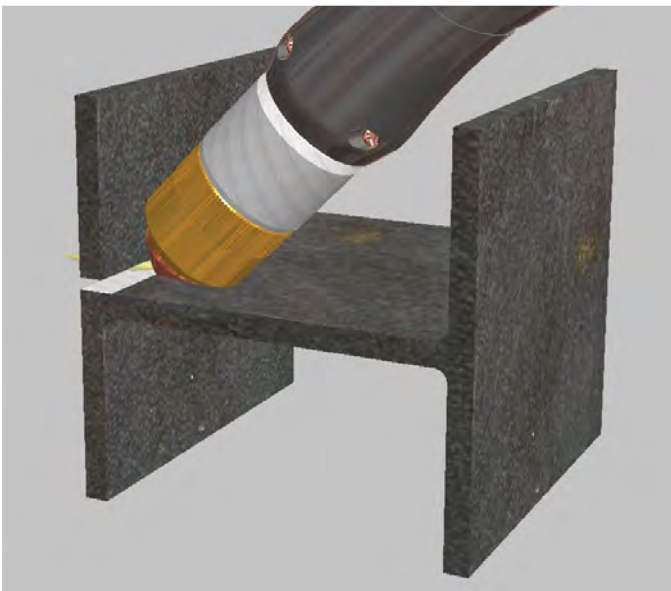
Code	Description	Pkg
53637	Standard KIT 85-125A	1
53638	Standard KIT 130-160A	1

BXEUPH-160FC



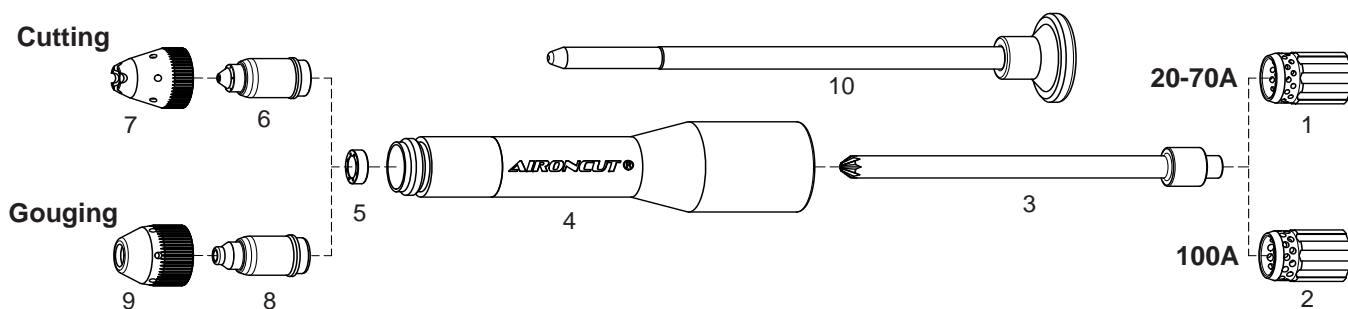
BXEUPH-160FC Kit 85-160A

Code	Description	Qty
53544	Electrode with Swirl Ring	1
53545	Retaining Cap	1
53535	Tip 85-125A	1
53536	Tip 130-160A	1
53543	Retaining Ring	1

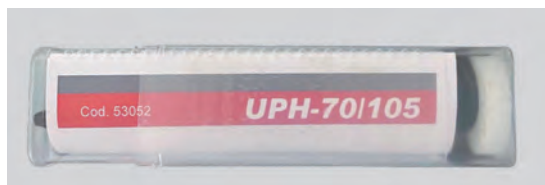
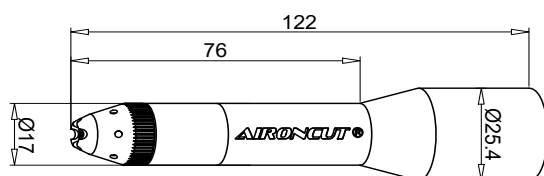


AIRONCUT®

New high visibility consumable system
to cut inaccessible parts.



For gouging use maximum 4 bar



53052 Standard Kit 70A Cutting

#	Code	Description	Pkg
1	60041E	Swirl Ring 20-70A	2
2	60024E	Swirl Ring 100A	2
3	53001	Electrode	3
4	53012	Shield Cup Body	1
5	53022	Vortex Ring	3
6	53031	Tip 20-45A	5
	53032	Tip 70A	5
	53034	Tip 100A	5
7	53047	Shield Cap Cutting	5
8	53036	Tip 50A Gouging	5
	53037	Tip 70A Gouging	5
	53038	Tip 100A Gouging	5
9	53046	Shield Cap Gouging	5
10	53080	Extractor for tip	1

BXAUPH105-AC



BXAUPH105-AC

Special Box

Code	Description	Qty
60041E	Swirl Ring 20-70A	1
60024E	Swirl Ring 100A	1
53001	Electrode	2
53022	Vortex Ring	2
53031	Tip 20-45A	3
53032	Tip 70A	3
53034	Tip 100A	5
53047	Shield Cap Cutting	2
53037	Tip 70A Gouging	3
53038	Tip 100A Gouging	5
53046	Shield Cap Gouging	2
53052	Standard Kit 70A Cutting	1

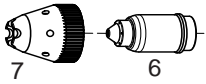
IT Util. Pat. Pend.:
N° IT202021000001583

45A	Max Thickness	8 mm
70A	Max Thickness	12.5 mm
100A	Max Thickness	20.0 mm

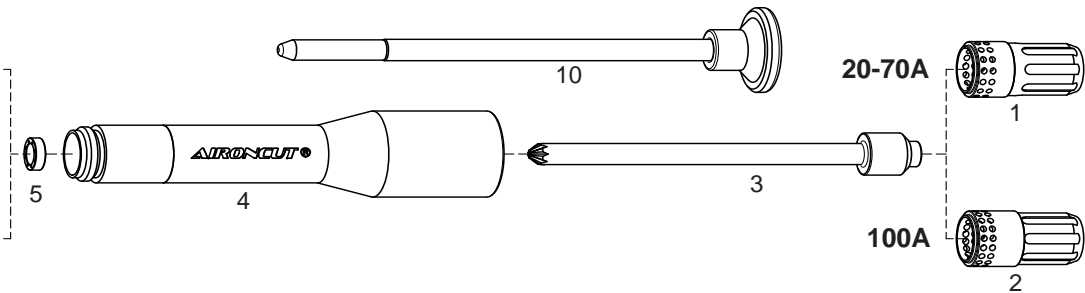
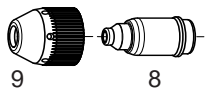
AIRONCUT®

New high visibility consumable system
to cut inaccessible parts.

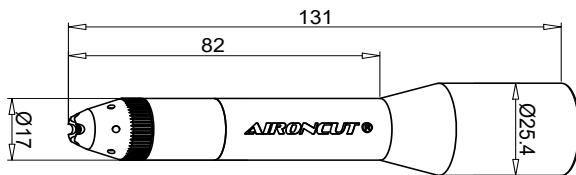
Cutting



Gouging



For gouging use maximum 4 bar



53152 Standard Kit 70A Cutting

#	Code	Description	Pkg
1	60042E	Swirl Ring 20-70A	2
2	60040E	Swirl Ring 100A	2
3	53101	Electrode	3
4	53112	Shield Cup Body	1
5	53022	Vortex Ring	3
6	53031	Tip 20-45A	5
	53032	Tip 70A	5
	53034	Tip 100A	5
7	53047	Shield Cap Cutting	5
8	53036	Tip 50A Gouging	5
	53037	Tip 70A Gouging	5
	53038	Tip 100A Gouging	5
9	53046	Shield Cap Gouging	5
10	53080	Extractor for tip	1

BXAUPH125-AC



BXAUPH125-AC

Special Box

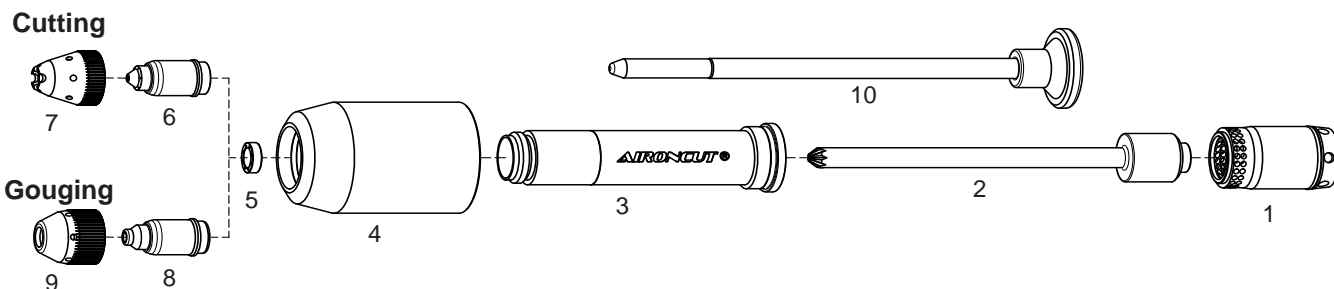
Code	Description	Qty
60042E	Swirl Ring 20-70A	1
60040E	Swirl Ring 100A	1
53101	Electrode	2
53022	Vortex Ring	2
53031	Tip 20-45A	3
53032	Tip 70A	3
53034	Tip 100A	5
53047	Shield Cap Cutting	2
53037	Tip 70A Gouging	3
53038	Tip 100A Gouging	5
53046	Shield Cap Gouging	2
53152	Standard Kit 70A Cutting	1

IT Util. Pat. Pend.:
N° IT202021000001583

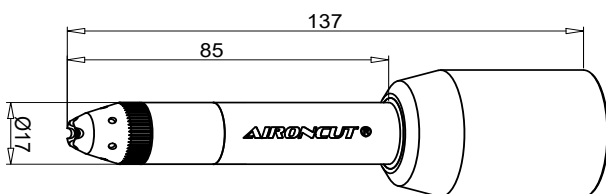
45A	Max Thickness	8 mm
70A	Max Thickness	12.5 mm
100A	Max Thickness	20.0 mm

AIRONCUT[®]

New high visibility consumable system to cut inaccessible parts.



For gouging use maximum 4 bar



53252 Standard Kit 70A Cutting

#	Code	Description	Pkg
1	60039E	Swirl Ring	2
2	53201	Electrode	3
3	53211	Shield Cup Body	1
4	53212	Retaining Cap	1
5	53022	Vortex Ring	3
6	53031	Tip 20-45A	5
	53032	Tip 70A	5
	53034	Tip 100A	5
7	53047	Shield Cap Cutting	5
8	53036	Tip 50A Gouging	5
	53037	Tip 70A Gouging	5
	53038	Tip 100A Gouging	5
9	53046	Shield Cap Gouging	5
10	53080	Extractor for tip	1

BXAUPH160-AC



BXAUPH160-AC

Special Box

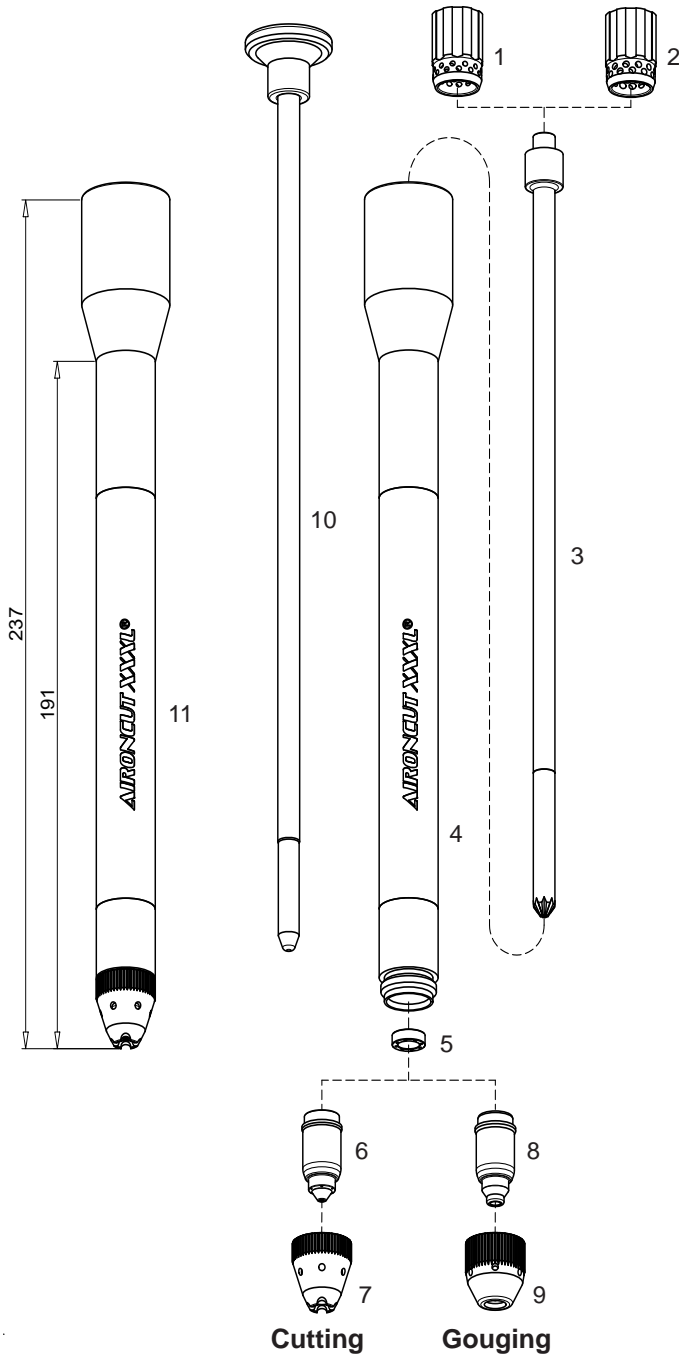
Code	Description	Qty
60039E	Swirl Ring	1
53201	Electrode	2
53022	Vortex Ring	2
53031	Tip 20-45A	3
53032	Tip 70A	3
53034	Tip 100A	5
53047	Shield Cap Cutting	2
53037	Tip 70A Gouging	3
53038	Tip 100A Gouging	5
53046	Shield Cap Gouging	2
53252	Standard Kit 70A Cutting	1

IT Util. Pat. Pend.:
N° IT202021000001583

45A	Max Thickness	8 mm
70A	Max Thickness	12.5 mm
100A	Max Thickness	20.0 mm

AIRONCUT XXXL®

New high visibility consumable system to cut inaccessible parts.



#	Code	Description	Pkg
1	60041E	Swirl Ring 20-70A	2
2	60024E	Swirl Ring 100A	2
3	53001L	Electrode **	3
4	53012L	Shield Cup Body	1
5	53022	Vortex Ring	3
6	53031	Tip 20-45A	5
	53032	Tip 70A	5
	53034	Tip 100A	5
7	53047	Shield Cap 20-100A	5
8	53036	Tip 50A Gouging	5
	53037	Tip 70A Gouging	5
	53038	Tip 100A Gouging	5
9	53046	Shield Cap Gouging	5
10	53080L	Extractor for tip	1
11	53052L	Complete Kit 70A Cutting	1



** Item not saleable in USA and Russia, being patented in said country.

Tec.Mo. accepts no responsibility in case of its customer's attempted sale in USA and Russia.



53052L Standard Kit 70A Cutting

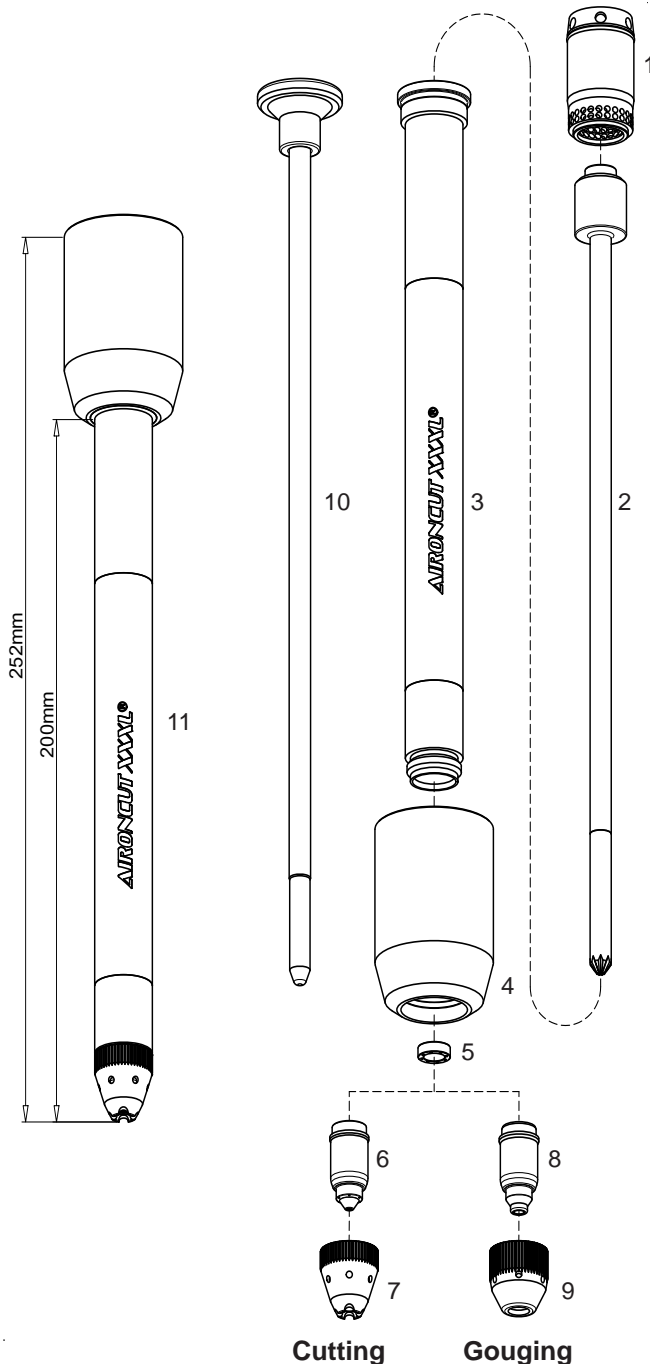
IT Util. Pat. Pend.:
N° IT202021000001583

For gouging use maximum 4 bar

45A	Max Thickness	8 mm
70A	Max Thickness	12.5 mm
100A	Max Thickness	20.0 mm

IRONCUT XXXL®

New high visibility consumable system to cut inaccessible parts.



#	Code	Description	Pkg
1	60039E	Swirl Ring	2
3	53201L	Electrode **	3
4	53211L	Shield Cup Body	1
5	53212	Retaining Cap	1
5	53022	Vortex Ring	3
6	53031	Tip 20-45A	5
	53032	Tip 70A	5
	53034	Tip 100A	5
7	53047	Shield Cap 20-100A	5
8	53036	Tip 50A Gouging	5
	53037	Tip 70A Gouging	5
	53038	Tip 100A Gouging	5
9	53046	Shield Cap Gouging	5
10	53080L	Extractor for tip	1
11	53252L	Complete Kit 70A Cutting	1



** Item not saleable in USA and Russia, being patented in said country.
 Tec.Mo. accepts no responsibility in case of its customer's attempted sale in USA and Russia.



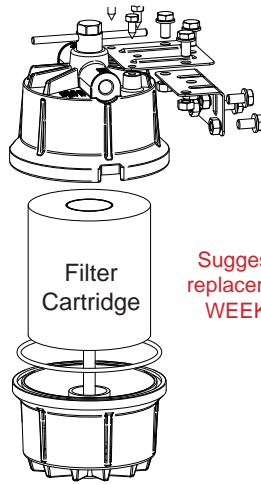
53252L Standard Kit 70A Cutting

IT Util. Pat. Pend.:
 N° IT202021000001583

For gouging use maximum 4 bar

45A	Max Thickness	8 mm
70A	Max Thickness	12.5 mm
100A	Max Thickness	20.0 mm

Air Filter AT1000



Air Filter Complete Code: 50500

Packaging:

Air Filter AT1000

Code: 50500-12

Carton Box: 12 Filters

Dimensions: 11" x 16.5" x h. 17.3"
(cm 28 x 42 x h. 44)

Weight: 43 lbs (19.5 kg)

Filter Cartridge

Code: 50505-8

Carton Box: 8 Cartridges

Dimensions: 8.58" x 8.58" x h. 9.61"
(cm 21.8 x 21.8 x h. 24.4)

Weight: 4.2 lbs (1.9 kg)

Code: 50505-48

Master Box: 8x6=48 Cartridges

Dimensions: 17.72" x 26.38" x h. 10.43"
(cm 45 x 67 x h. 26.5)

Weight: 26.7 lbs (12.1 kg)

"AT 1000" is the perfect solution to the problems created by the contamination of the compressed air used in many plasma cutting systems.

It eliminates "sputter" caused by moisture and oil from compressed air lines.

It extends the electrode and nozzle life, with obvious benefits to the cut quality.

Designed to remove aerosol oil and moisture, "AT 1000" is a real benefit, entrapping particles as small as .01 microns inches.

With "AT 1000" torches last longer. Without this filter, at the end of this cutting session, inside the torch and torch head you have left condensed moisture, that can cause a short-circuit, with consequent rise of costs coming from the replacement of the torch head and the needed time to realize this operation.

"AT 1000" can filter up to 1250 liters a minute without reduction in pressure.

It's recommended to replace the filter cartridge every 5 to 7 days (max).

It's also very suitable for painters and use of pneumatic tools.

Our excellent knowhow in the production of plasma cutting torches and the consequent problems of air contaminant brought us to create the "AT 1000" being very effective and important for users of plasma cutting systems.

BEVEL TOOL



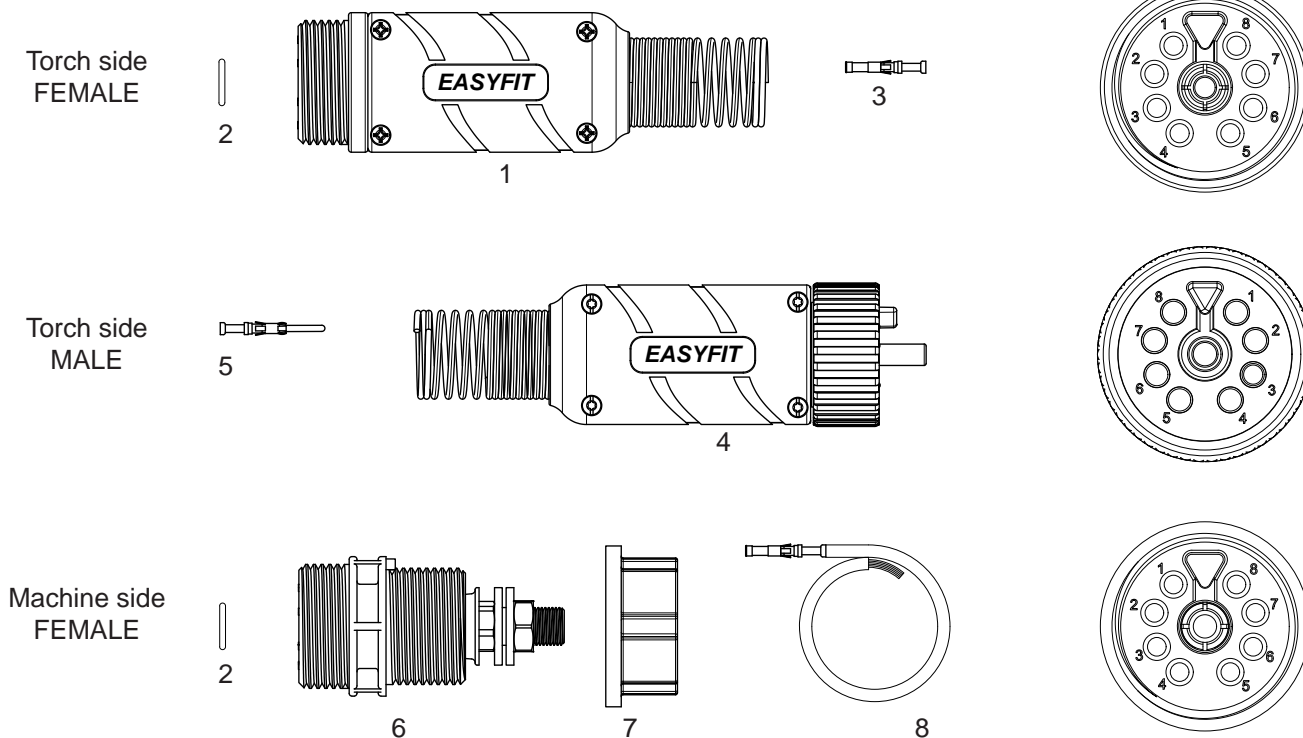
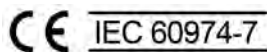
Code Description

51880 PMAX 1000/1250/1650® - PMAX 45/65/85/105® - TH-70/105/125 - UPH-70/105/125

51886 PMAX 125® - TEC.MO.® TH-160 - UPH-160

EASY FIT Connector

Registered Community Design



Item	Description	Code
1	Complete KIT EASYFIT Female - for cables with crimped connection	05266RPT
2	O-Ring - (conf.20 pcs)	20850.41
3	Contact pin female - (conf.10 pcs)	05265.45
4	Complete KIT EASYFIT Male - for cables with crimped connection	05261RPT
5	Contact pin male - (conf.10 pcs)	05260.45
6	Machine connector EASYFIT (standard connection 6 pins)	05265
	Machine connector EASYFIT (connection 7 pins)	05265-7
	Machine connector EASYFIT (connection 8 pins)	05265-8
7	Hexagonal Nut	04265.41
8	Contact pin, BLACK lead, 0.75mm ² x 600mm	04265.21
	Contact pin, RED lead, 0.75mm ² x 600mm	04265.22
	Contact pin, BLUE lead, 0.75mm ² x 600mm	04265.23
	Contact pin, BROWN lead, 0.75mm ² x 600mm	04265.24
	Contact pin, WHITE lead, 0.75mm ² x 600mm	04265.25

35+
Years

TEC.MO.
=

Quality
Technology
Innovation